

OREGON LAKES AND RESERVOIRS

HARNEY AND MALHEUR COUNTIES

**MASTER PLAN
FOR ANGLER ACCESS AND
ASSOCIATED RECREATIONAL
USES**



**Oregon State Game Commission
Lands Division**



OREGON LAKES AND RESERVOIRS
Harney and Malheur Counties
Master Plan for Angler Access
and
Associated Recreational Uses

By

Oregon State Game Commission

Lands Section

December 1967

T A B L E O F C O N T E N T S

THE PLAN	1
VICINITY MAP	3
HARNEY COUNTY LAKES	4
WARM SPRINGS RESERVOIR	47
MALHEUR COUNTY LAKES	59
BEULAH RESERVOIR	64
BULLY CREEK RESERVOIR	73
MALHEUR RESERVOIR	89
OWYHEE RESERVOIR	100
APPENDIX - Harney County Map	
Malheur County Map	

OREGON LAKES AND RESERVOIRS
Harney and Malheur Counties
Master Plan for Angler Access
and
Associated Recreational Uses

This report details a plan that we hope can be followed to solve access problems and provide additional recreational waters in Harney and Malheur Counties. Too, we hope that all agencies that are interested in retaining existing water access as well as providing additional facilities, whether they be municipal, county, or state will all join in a cooperative effort to carry out this plan in an orderly manner. It is probable that Land and Water Conservation Funds will be available on a 50-50 matching basis. In order to acquire these funds, it will be necessary to apply through the Oregon State Highway Department.

Harney and Malheur Counties are Oregon's two largest counties. They cover the entire southeast corner of the state.

Topography is diversified in a minor sense of the word. The entire area is dry, but the northern part of Harney County receives adequate rainfall to support a pine forest. Southern Harney County and most of Malheur County are arid and only support juniper and sagebrush.

The elevation is over 4,000 feet in Harney County with Steens Mountain reaching 9,000 feet. Malheur County is not as high as the average, but the desert in the southern part of the county has peaks that spire to 7,000 feet. The average topography is well over 4,000 feet.

Since this area is so dry there has been considerable effort during past years to establish reservoirs for irrigation storage. For this reason, over 90% of the lakes in these counties are man made reservoirs. In some

instances, the establishment of a fishery is difficult because of annual irrigation drawdown. So, it is recommended that minimum pools be established on reservoirs of this type.

The fishery in most of these lakes is for trout. The rich composition of the land makes rich reservoirs that grow trout and warm-water game fish at a fantastic rate. Fingerling fish that are stocked early in the spring usually attain a length of 10 inches by early fall. This is a growth rate of over an inch a month. These fish are heavily bodied and in excellent condition.

All lakes in the two counties are open to fishing the entire year except Malheur and Krumbo Reservoirs. The summer bag limit of 10 fish over 6 inches in length per day with 20 in possession, or in 7 consecutive days is in effect. Malheur and Krumbo Reservoirs open in the latter part of April and remain open until the end of October. The same bag limit is in effect.

We realize in writing a plan of this type that we have not covered all of the potential impoundment sites available. What we have attempted to include are those existing and potential bodies of water that provide or could be developed to provide significant recreation at economically feasible costs. New sites or modifications of existing sites that fit this criteria may be added to this report by supplement in the future.

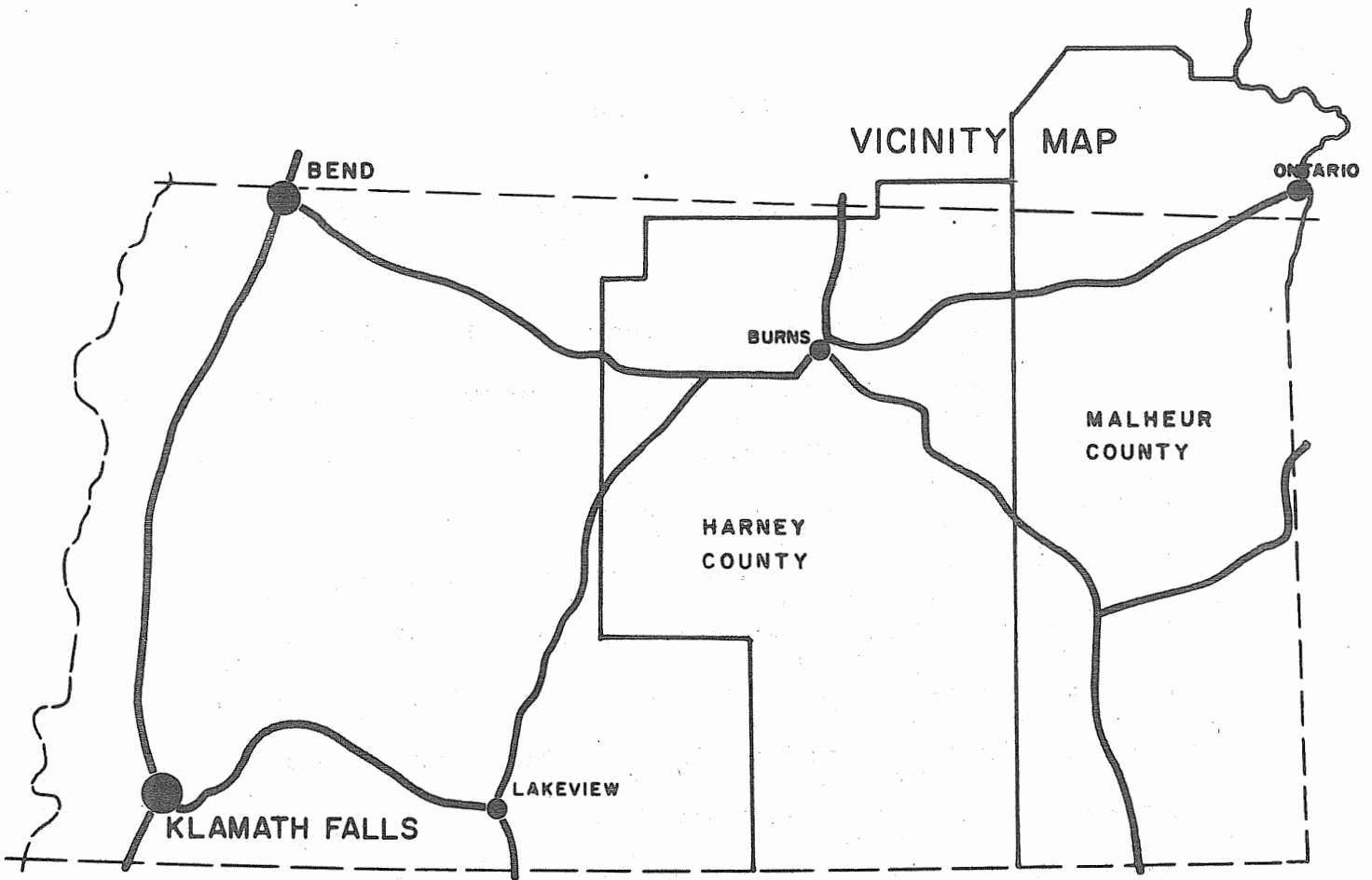

Harney and Malheur Counties are located in the southeastern corner of the state. Burns and Ontario are 130 and 261 miles from Bend, respectively. Oregon Highway 20 serves the northern parts of the counties where the population is centered. Oregon Highway 78 serves southern Malheur County, and connects with U. S. 95 between Boise, Idaho and Winnemucca, Nevada.

HARNEY COUNTY LAKES

Harney County is the largest county in Oregon. It covers 10,132 square miles but only has 7,200 inhabitants.

The northern part of the county is invaded by the southern edge of the Ochoco National Forest. It is a beautiful area of mature ponderosa pine with little brush to clutter the understory. The central part of the county is characterized by rolling sagebrush covered hills and broad, level valleys. Some of the area is irrigated for hay production. Malheur National Wildlife Refuge is situated in the center of this area. To the south, the Steens Mountain climbs to its summit of 9,670 feet to drop off sharply into the Alvord Desert. The Pueblo and Trout Creek Mountains occupy the southern end of the county adjacent to the Nevada border.

Many of the lakes in the county are dry or form the dead end of a short drainage. These lakes are entirely dependent upon the annual rainfall for maintenance of a water level. Many go dry each summer; some have decreased drastically in area in past years because of minimum annual rainfall.

All lakes in the county have road access except Wildhorse Lake on the east side of the Steens Mountain. A trail is recommended for access to this lake. The other lakes in the county are either complete and adequate for recreational use, need an access road, campground and/or boat ramp, or the establishment of a minimum pool for fish propagation. Many of these reservoirs are drained completely each year for irrigation, consequently, a fish population cannot be maintained from one year to the next. Many of the reservoirs in this plan are of this character and it is recommended that minimum pools be established even for a price, if necessary.

A few proposed reservoirs are listed with priorities attached. These sites have potential for construction of reservoirs which would be suitable for fish production. We hope that some public agency can appropriate 50% of the cost so a few of these sites will some day produce recreational fishing.

LAKE AND RESERVOIR ACCESS EVALUATION

Middle Fork Malheur System

Harney County Area Priority B
Name Altnow Pond County Harney

Location 14 miles north of Drewsey
Township 20 S Range 36 E Sec. 4 Tax Lot No. _____
Ownership Private Number of owners 1

DESCRIPTION

Terrain Rolling mountains
Cover type Grass and sagebrush
Existing access Public road
Surface acres 17 Water quality Excellent * Levels Stable
Present stage of development Complete

* Spring fed

ANGLER NEEDS

Acquisition: _____ acres, _____ of frontage
Type of conveyance Purchase reservoir

Development:

Boat ramp: Type _____ Number of lanes _____
Toilets _____ Trails _____ Roads _____
Parking area _____; for _____ cars or _____ car-trailer units

This site should be purchased or brought under public access if at all
possible.

LAKE AND RESERVOIR ACCESS EVALUATION

South Fork Malheur System

Harney County Area

Priority B

Name Alder Creek Reservoir

County Harney

Location 6 miles east of Crane

Township 25 S Range 35 E Sec. 19 Tax Lot No. _____

Ownership Private Number of owners 1

DESCRIPTION

Terrain Rolling mountains

Cover type Sagebrush, juniper and grass

Existing access Private dirt road

Surface acres 22 Water quality Fair Levels Fluctuate

Present stage of development None

ANGLER NEEDS

Acquisition: _____ acres, _____ of frontage

Type of conveyance Purchase reservoir

Development:

Boat ramp: Type _____ Number of lanes _____

Toilets _____ Trails _____ Roads _____

Parking area _____; for _____ cars or _____ car-trailer units

This site should be purchased or brought under public access if at all possible.

FISHERY: Rainbow trout up to 12 inches.

Spring Summer Fall Winter

Heavy

--	--	--	--

Medium

--	--	--	--

Light

Tr			
----	--	--	--

(Sa - Salmon, Tr - Trout,
Ww - Warm Water Fishes)

SKETCH

(See Harney County map for location)

Seasons (Check)

RECREATION
(Check)

- Boating, motor
- Boating, non-motor
- Camping, tent
- Camping, trailer
- Fishing, boat
- Fishing, shore
- Hiking
- Horseback riding
- Hunting, big game
- Hunting, upland game
- Hunting, waterfowl
- Nature study
- Picnicking
- Sightseeing
- Skin and scuba diving
- Swimming
- Water skiing

	Spring	Summer	Fall	Winter
	x	x	x	

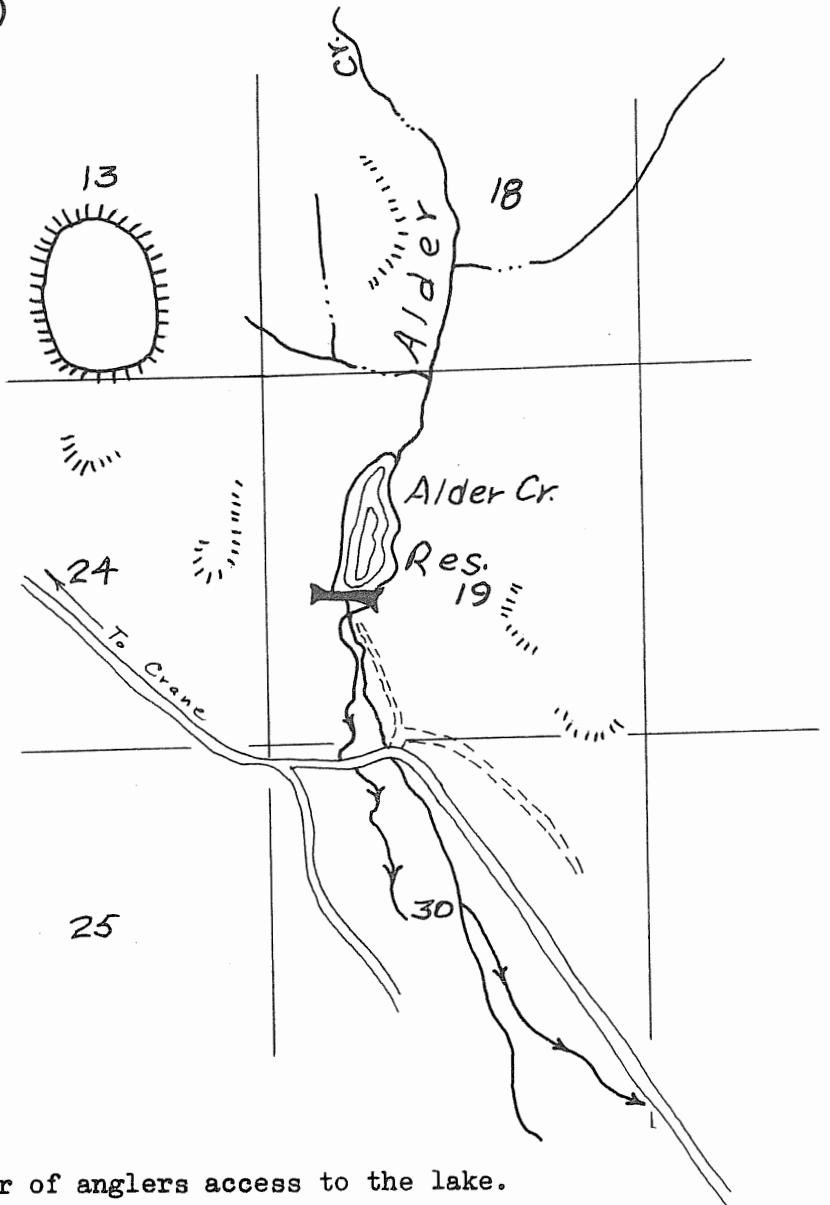

OTHER

Safety Problems:

Group Facilities:

REMARKS

The owner allows a limited number of anglers access to the lake.

LAKE AND RESERVOIR ACCESS EVALUATION

Malheur River System
Harney County Area Priority C
Name Calamity Creek Reservoir County Harney

Location Seven miles upstream from Van
Township 18 S Range 33 E Sec. 30 Tax Lot No. 1
Ownership U.S. Forest Service & Private Number of owners 2

DESCRIPTION

Terrain Rolling mountains
Cover type Lodgepole pine and sagebrush
Existing access Single lane dirt - county
Surface acres 35 Water quality Good Levels _____
Present stage of development None

ANGLER NEEDS

Acquisition: _____ acres, _____ of frontage
Type of conveyance Easement if needed for access to lake.

Development:

Boat ramp: Type Concrete plank Number of lanes 1
Toilets X Trails _____ Roads to boat ramp
Parking area X; for _____ cars or 2 car-trailer units

This site will accommodate a reservoir fishery.

Name Calamity Creek
Reservoir

FISHERY: Trout

	Spring	Summer	Fall	Winter
Heavy				
Medium				
Light				

(Sa - Salmon, Tr - Trout,
Ww - Warm Water Fishes)

SKETCH

(See Harney County map for
location)

Seasons (Check)

RECREATION
(Check)

- Boating, motor
- Boating, non-motor
- Camping, tent
- Camping, trailer
- Fishing, boat
- Fishing, shore
- Hiking
- Horseback riding
- Hunting, big game
- Hunting, upland game
- Hunting, waterfowl
- Nature study
- Picnicking
- Sightseeing
- Skin and scuba diving
- Swimming
- Water skiing

	Spring	Summer	Fall	Winter
Boating, motor	X	X	X	
Boating, non-motor	X	X	X	
Camping, tent	X	X	X	
Camping, trailer	X	X	X	
Fishing, boat	X	X	X	
Fishing, shore	X	X	X	
Hiking				
Horseback riding				
Hunting, big game				
Hunting, upland game				
Hunting, waterfowl				
Nature study				
Picnicking	X	X	X	
Sightseeing				
Skin and scuba diving				
Swimming				
Water skiing				

OTHER

Safety Problems:

Group Facilities:

REMARKS

At the present time there is good trout angling during the first two weeks of trout season in the creek above and below the dam site.

LAKE AND RESERVOIR ACCESS EVALUATION

Silver Creek System
Harney County Area Priority A
Name Chickahominy Reservoir County Harney

Location 33 miles west of Burns on Highway 95
Township 23 S Range 26 E Sec. Many Tax Lot No. _____
Ownership BLM and private Number of owners 2

DESCRIPTION

Terrain Rolling hills
Cover type Sagebrush and grass
Existing access Gravel road
Surface acres 525 Water quality Good Levels Fluctuate
Present stage of development Campground on public land

ANGLER NEEDS

Acquisition: _____ acres, _____ of frontage
Type of conveyance _____

Development:
Boat ramp: Type Concrete plank Number of lanes 2
Toilets X Trails _____ Roads _____
Parking area _____; for _____ cars or _____ car-trailer units

This site in years past provided an excellent trout fishery but new owner-
ship has completely drained the reservoir for irrigation.

Name Chickahominy Res.

FISHERY: Rainbow trout. To maintain a fishery in the reservoir a minimum pool will need to be maintained. The "A" priority is for establishment of a minimum pool.

	Spring	Summer	Fall	Winter
Heavy	Tr			
Medium		Tr		
Light			Tr	

(Sa - Salmon, Tr - Trout, Ww - Warm Water Fishes)

SKETCH

(See Harney County map for location)

Seasons (Check)

RECREATION
(Check)

- Boating, motor
- Boating, non-motor
- Camping, tent
- Camping, trailer
- Fishing, boat
- Fishing, shore
- Hiking
- Horseback riding
- Hunting, big game
- Hunting, upland game
- Hunting, waterfowl
- Nature study
- Picnicking
- Sightseeing
- Skin and scuba diving
- Swimming
- Water skiing

	Spring	Summer	Fall	Winter
X	X	X		
X	X	X		
X	X	X		
X	X	X		
X	X	X		
X	X	X		
X	X	X		
X	X	X		

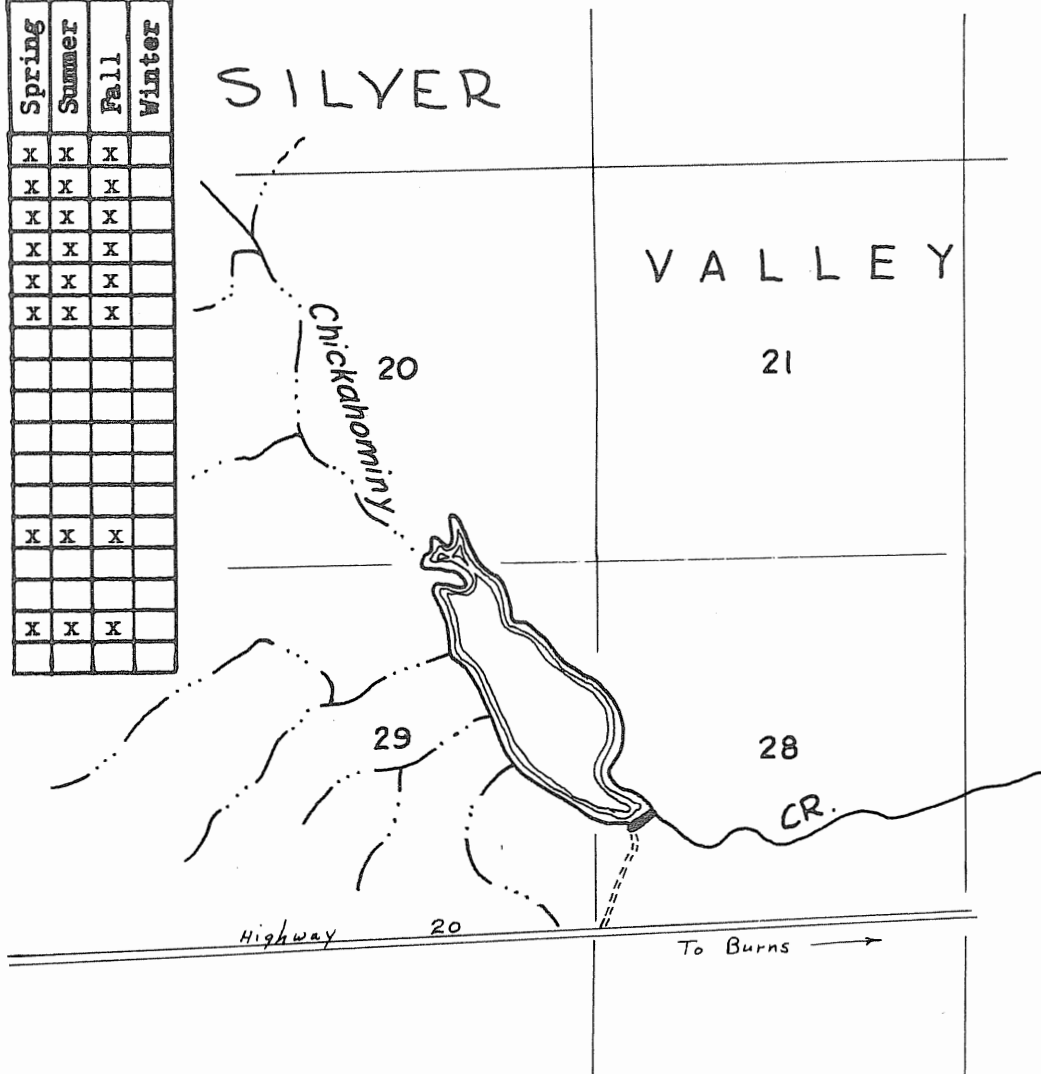

OTHER

Safety Problems:

Group Facilities:

REMARKS

The reservoir has been completely drained for irrigation this year (1967). If this is done every year it will be difficult to maintain a fishery. The BLM has plans to build a boat ramp.

LAKE AND RESERVOIR ACCESS EVALUATION

Silver Creek System
Harney County Area Priority B
Name Claw Creek Impoundment (Proposed) County Harney

Location 20 miles northwest of Riley
Township 21 S Range 26 E Sec. 27 Tax Lot No. _____
Ownership Private Number of owners _____

DESCRIPTION

Terrain Rolling hills
Cover type Sagebrush and juniper
Existing access Public gravel road
Surface acres _____ Water quality Good Levels Fluctuate
Present stage of development Proposed impoundment

ANGLER NEEDS

Acquisition: _____ acres, _____ of frontage
Type of conveyance _____

Development:

Boat ramp: Type Gravel Number of lanes 1
Toilets X Trails _____ Roads X
Parking area X; for _____ cars or 50 car-trailer units

This site is in an ideal location for an irrigation impoundment. To provide a fishery a minimum pool would need to be obtained.

LAKE AND RESERVOIR ACCESS EVALUATION

Malheur System
Harney County Area Priority C
Name Cottonwood Creek Reservoir County Harney
(Otis Valley Reservoir)

Location 9 miles northeast of Drewsey
Township 19 S Range 36 E Sec. 9 & 4 Tax Lot No. * 2
Ownership BLM Number of owners _____
* Access road through Section 16

DESCRIPTION

Terrain Rolling mountains
Cover type Juniper, sagebrush and grass
Existing access Private improved dirt road *
Surface acres 120+ Water quality Excellent Levels Fluctuate
Present stage of development BLM has proposed plans

ANGLER NEEDS

Acquisition: _____ acres, _____ of frontage
Easements along existing road over private
Type of conveyance land

Development:

Boat ramp: Type Concrete plank Number of lanes 1
Toilets X Trails _____ Roads _____
Parking area X; for _____ cars or 20 car-trailer units

This site will accommodate anglers on Cottonwood Creek Reservoir.

* On the general highway map of Harney County prepared by the Oregon State Highway Department in cooperation with the US Bureau of Public Roads, this road is designated as a "Public Usage - Private Road".

FISHERY: Rainbow trout are running 10" - 12". The fish were stocked in spring of 1967 and attained this size by September of the same year.

	Spring	Summer	Fall	Winter
Heavy				
Medium	Tr	Tr	Tr	
Light				

(Sa - Salmon, Tr - Trout, Ww - Warm Water Fishes)

SKETCH

(See Harney County map for location)

Seasons (Check)

RECREATION
(Check)

- Boating, motor
- Boating, non-motor
- Camping, tent
- Camping, trailer
- Fishing, boat
- Fishing, shore
- Hiking
- Horseback riding
- Hunting, big game
- Hunting, upland game
- Hunting, waterfowl
- Nature study
- Picnicking
- Sightseeing
- Skin and scuba diving
- Swimming
- Water skiing

	Spring	Summer	Fall	Winter
X	X	X		
X	X	X		
X	X	X		
X	X	X		
X	X	X		
X	X	X		
			X	
			X	
X	X	X		
X	X	X		
X	X	X		

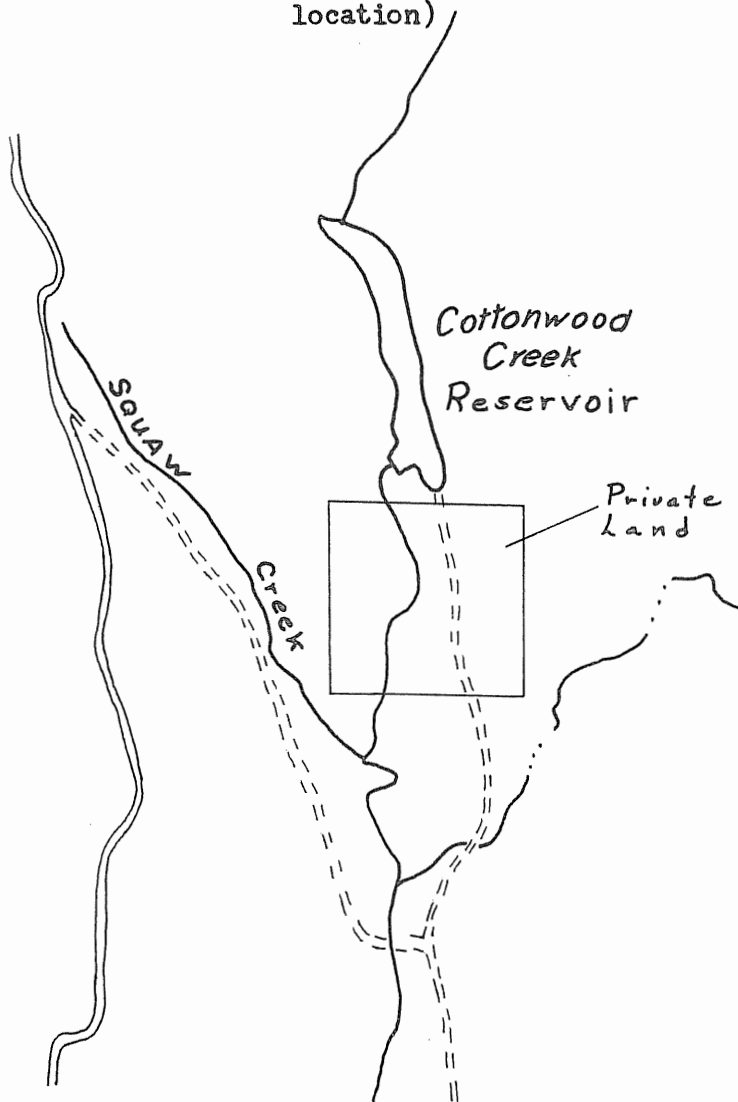

OTHER

Safety Problems:

Group Facilities:

REMARKS

Angling pressure is just starting since the lake was first stocked in the spring of 1967. The Otis Valley Irrigation Company built the reservoir in cooperation with the Soil Conservation Service and its primary use will be for irrigation.

LAKE AND RESERVOIR ACCESS EVALUATION

Harney County Area Priority B
Name Little Crane Creek Reservoir County Harney
Location 9 miles northeast of Crane
Township 24 S Range 35 E Sec. 27 Ownership Private

DESCRIPTION

Terrain Rimrocks and rolling mountains
Cover type Sagebrush and grass
Elevation 5,000'+ Acre/feet 356 Water quality Good
Existing access None

ANGLER NEEDS

Establish a fishery and make the reservoir available to the public.

FISHERY

None

	Spring	Summer	Fall	Winter		<u>Recreation</u>			
						S	S	F	W
Heavy					Camping				
Medium					Fishing, boat				
Light					Fishing, shore				
					Hiking				
					Horseback riding				
					Hunting, big game				
					Hunting, upland game				
					Nature study				
					Picnicking				
					Sight-seeing				
					Swimming				
					Water skiing				

(Ct - Cutthroat trout, GT - Golden trout, LT - Lake trout, BT - Brook trout, Rb - Rainbow trout, Br - Brown trout, K - Kokanee, Ww - Warm water game fish)

REMARKS:

It would be desirable to purchase this reservoir if ever possible and establish a fishery.
See Harney County map for location.

LAKE AND RESERVOIR ACCESS EVALUATION

Silver Creek System
Harney County Area Priority Complete
Name Delintment Lake County Harney

Location 45 miles northwest of Burns
Township 19 S Range 26 E Sec. 29 Tax Lot No. _____
Ownership U. S. Forest Service Number of owners _____

DESCRIPTION

Terrain Rolling mountains
Cover type Ponderosa Pine and sagebrush
Existing access Single-lane dirt road
Surface acres 52 Water quality Excellent Levels Stable
Present stage of development Complete

ANGLER NEEDS

Acquisition: _____ acres, _____ of frontage
Type of conveyance _____

Development:

Boat ramp: Type _____ Number of lanes _____
Toilets _____ Trails _____ Roads _____
Parking area _____; for _____ cars or _____ car-trailer units

This site has camping and picnic facilities with a gravel boat ramp.

Name Delintment Lake

FISHERY: Rainbow trout - The lake usually winter kills each winter, however, 8" trout stocked in the spring attain 15"-16" by fall.

	Spring	Summer	Fall	Winter
Heavy				
Medium		Tr	Tr	
Light				

(Sa - Salmon, Tr - Trout, Ww - Warm Water Fishes)

SKETCH

(See Harney County map for location)

Seasons (Check)

RECREATION
(Check)

- Boating, motor
- Boating, non-motor
- Camping, tent
- Camping, trailer
- Fishing, boat
- Fishing, shore
- Hiking
- Horseback riding
- Hunting, big game *
- Hunting, upland game
- Hunting, waterfowl
- Nature study
- Picnicking
- Sightseeing
- Skin and scuba diving
- Swimming
- Water skiing
- * Deer & elk

	Spring	Summer	Fall	Winter
Boating, motor	x	x	x	
Boating, non-motor	x	x	x	
Camping, tent	x	x	x	
Camping, trailer	x	x	x	
Fishing, boat	x	x	x	
Fishing, shore	x	x	x	
Hiking				
Horseback riding				
Hunting, big game *			x	
Hunting, upland game				
Hunting, waterfowl				
Nature study				
Picnicking		x	x	
Sightseeing				
Skin and scuba diving				
Swimming		x	x	
Water skiing				

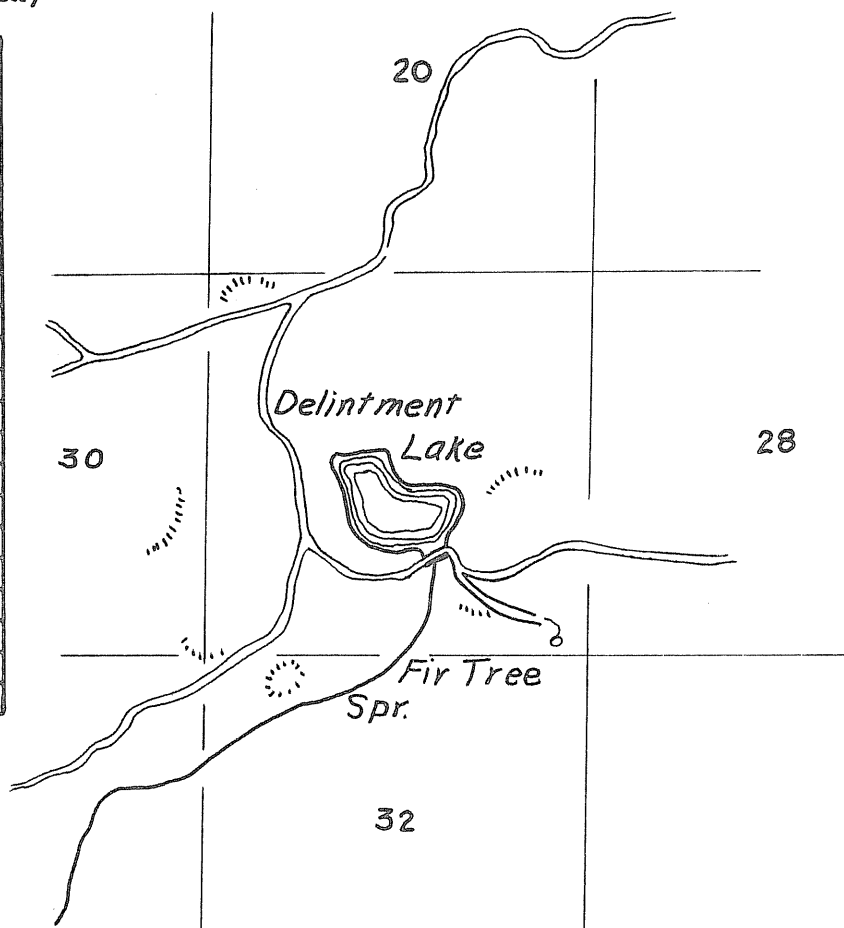

OTHER

Safety Problems: Roads are impassable in winter and early spring.

Group Facilities:

REMARKS

This is a beautiful lake among tall pines. The area is used heavily during deer season by hunters that also want to fish.

LAKE AND RESERVOIR ACCESS EVALUATION

Silvies System
Harney County Area Priority C
Name Dipping Vat Spring Impoundment County Harney
(Proposed)

Location 9 miles southeast of Delintment Lake
Township 20 S Range 27 E Sec. 4 Tax Lot No. _____
Ownership U.S. Forest Service Number of owners 1

DESCRIPTION

Terrain Rolling mountains
Cover type Ponderosa Pine
Existing access Good logging road - last 1/2 mile unimproved
Surface acres 60-80 Water quality Excellent * Levels Stable
Present stage of development None

* The source of water would be spring runoff.

ANGLER NEEDS

Acquisition: _____ acres, _____ of frontage
Type of conveyance _____

Development:

Boat ramp: Type Gravel Number of lanes 1
Toilets X Trails _____ Roads X
Parking area X; for _____ cars or 25 car-trailer units

This site would provide a trout fishery in north Harney County.

Name

ANTICIPATED
FISHERY:

Trout

Spring Summer Fall Winter

Heavy

--	--	--	--

Medium

--	--	--	--

Light

--	--	--	--

(Sa - Salmon, Tr - Trout,
Ww - Warm Water Fishes)

SKETCH

(See Harney County map for
location)

Seasons (Check)

RECREATION
(Check)

- Boating, motor
- Boating, non-motor
- Camping, tent
- Camping, trailer
- Fishing, boat
- Fishing, shore
- Hiking
- Horseback riding
- Hunting, big game
- Hunting, upland game
- Hunting, waterfowl
- Nature study
- Picnicking
- Sightseeing
- Skin and scuba diving
- Swimming
- Water skiing

	Spring	Summer	Fall	Winter
X	X	X	X	
X	X	X	X	
X	X	X	X	
X	X	X	X	
X	X	X	X	
X	X	X	X	
			X	
X	X	X		
		X	X	

OTHER

Safety Problems:

Group Facilities:

REMARKS

This is a good site for an impoundment. It would be spring fed resulting in excellent water quality. The impoundment would flood a meadow.

LAKE AND RESERVOIR ACCESS EVALUATION

Silvies System
Harney County Area Priority B
Name Emigrant Reservoir (Proposed) County Harney

Location 22 miles northwest of Burns on the Izee road
Township 20 S Range 28 E Sec. 36 Tax Lot No. _____
Ownership Private Number of owners 1

DESCRIPTION

Terrain Rolling mountains
Cover type Sagebrush and juniper
Existing access Two-lane gravel road (public)
Surface acres _____ Water quality Excellent Levels _____
Present stage of development None

ANGLER NEEDS

Acquisition: _____ acres, _____ of frontage
Type of conveyance _____

Development:

Boat ramp: Type Gravel Number of lanes 2
Toilets X Trails _____ Roads X
Parking area X; for _____ cars or 150 car-trailer units

This site would form a large reservoir with a good live stream with plenty
of spawning area.

LAKE AND RESERVOIR ACCESS EVALUATION

Donner & Blitzen System
Harney County Area Priority Complete
Name Fish Lake County Harney

Location Head of Lake Creek, 17 miles above Frenchglen
Township 32 $\frac{1}{2}$ S Range 33 E Sec. 29 Tax Lot No. _____
Ownership Oregon State Game Commission Number of owners _____

DESCRIPTION

Terrain High mountain desert near summit of Steens Mountain
Cover type Sage and bunchgrass with aspen and willow around lake.
Existing access Public two-lane dirt road
Surface acres 20 Water quality Excellent Levels Stable
Present stage of development Complete

ANGLER NEEDS

Acquisition: _____ acres, _____ of frontage
Type of conveyance _____

Development:

Boat ramp: Type _____ Number of lanes _____

Toilets _____ Trails _____ Roads _____

Parking area _____; for _____ cars or _____ car-trailer units

This site will accommodate campers, hunters, fishermen and picnickers.

Name Fish Lake

FISHERY: Rainbow and brook trout.

	Spring	Summer	Fall	Winter
Heavy		Tr		
Medium			Tr	
Light				Tr

(Sa - Salmon, Tr - Trout,
Ww - Warm Water Fishes)

SKETCH

(See Harney County map for location)

Seasons (Check)

RECREATION
(Check)

	Spring	Summer	Fall	Winter
Boating, motor		X	X	
Boating, non-motor		X	X	
Camping, tent		X	X	
Camping, trailer		X	X	
Fishing, boat		X	X	
Fishing, shore		X	X	
Hiking		X	X	
Horseback riding				
Hunting, big game		X	X	
Hunting, upland game		X	X	
Hunting, waterfowl				
Nature study		X	X	
Picnicking		X	X	
Sightseeing		X	X	
Skin and scuba diving				
Swimming		X	X	
Water skiing				

OTHER

Safety Problems:

Group Facilities: Picnicking and camping

REMARKS

The lake is stocked with 7,000 legal rainbow per year.

The area can only be reached in early July through mid-October because of snow. A concession stand is operated during the summer months; fishing tackle and food materials are available. Tables are located throughout the

LAKE AND RESERVOIR ACCESS EVALUATION

Alvord System
Harney County Area Priority C
Name Hot Lake County Harney

Location 7 miles north of Fields
Township 37 S Range 33 E Sec. 15 Tax Lot No. _____
Ownership _____ BLM Number of owners _____

DESCRIPTION

Terrain Flat alkali desert
Cover type Sagebrush, greasewood, grass
Existing access Public dirt road
Surface acres 6 Water quality Good Levels Stable
Present stage of development None

ANGLER NEEDS

Acquisition: _____ acres, _____ of frontage
Type of conveyance _____

Development:

Boat ramp: Type _____ Number of lanes _____
Toilets X Trails _____ Roads _____
Parking area _____; for _____ cars or _____ car-trailer units

This area is used by deer, antelope and chukar hunters as a camping site.

Name Hot Lake

FISHERY: Cutthroat trout

	Spring	Summer	Fall	Winter
Heavy				
Medium				
Light	Tr	Tr	Tr	

(Sa - Salmon, Tr - Trout, Ww - Warm Water Fishes)

SKETCH

(See Harney County map for location)

Seasons (Check)

RECREATION
(Check)

- Boating, motor
- Boating, non-motor
- Camping, tent
- Camping, trailer
- Fishing, boat
- Fishing, shore
- Hiking
- Horseback riding
- Hunting, big game
- Hunting, upland game
- Hunting, waterfowl
- Nature study
- Picnicking
- Sightseeing
- Skin and scuba diving
- Swimming
- Water skiing

	Spring	Summer	Fall	Winter
	X	X	X	
		X	X	
	X	X	X	
			X	
			X	X
			X	X
		X	X	

OTHER

Safety Problems:

Group Facilities:

REMARKS

This lake gets heavy use by waterfowl because it never freezes. The lake only gets light fishing pressure.

LAKE AND RESERVOIR ACCESS EVALUATION

Northeast Steens System
Harney County Area Priority B
Name Juniper Lake County Harney

Location 50 miles south of Crane
Township 30 & 31 S Range 36 E Sec. 36 & 31 Tax Lot No. _____
Ownership BLM and private Number of owners 2

DESCRIPTION

Terrain Valley between steep mountains
Cover type Sagebrush and grass
Existing access County road
Surface acres 100+ Water quality Good Levels Fluctuate
Present stage of development None

ANGLER NEEDS

Acquisition: _____ acres, _____ of frontage
Type of conveyance _____

Development:

Boat ramp: Type _____ Number of lanes _____

Toilets X Trails _____ Roads _____

Parking area _____; for _____ cars or _____ car-trailer units

Other development: Establishment of campsites.

This site makes a cool camping area for deer and antelope hunters in the
fall.

Name Juniper Lake

FISHERY: Rainbow trout about 11" - 12"

	Spring	Summer	Fall	Winter
Heavy				
Medium				
Light	Tr	Tr	Tr	

(Sa - Salmon, Tr - Trout,
Ww - Warm Water Fishes)

SKETCH

Seasons (Check)

RECREATION
(Check)

- Boating, motor
- Boating, non-motor
- Camping, tent
- Camping, trailer
- Fishing, boat
- Fishing, shore
- Hiking
- Horseback riding
- Hunting, big game
- Hunting, upland game
- Hunting, waterfowl
- Nature study
- Picnicking
- Sightseeing
- Skin and scuba diving
- Swimming
- Water skiing

	Spring	Summer	Fall	Winter
		X	X	
		X	X	
			X	

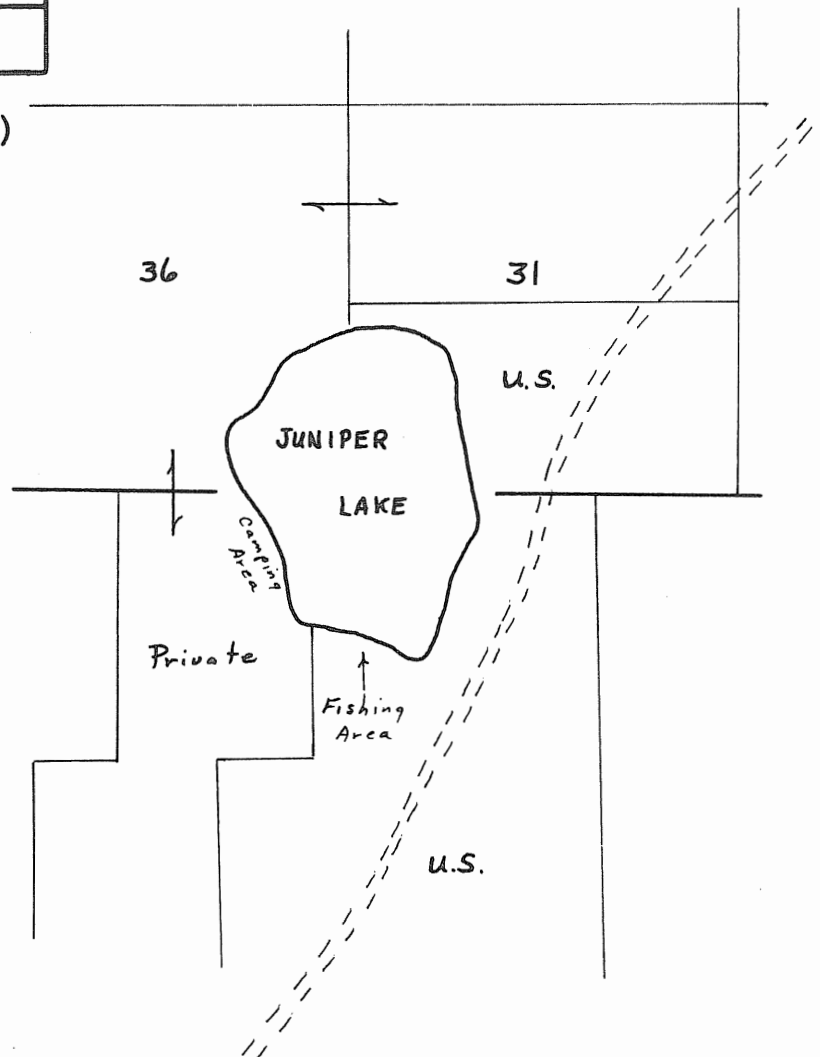

OTHER

Safety Problems:

Group Facilities:

REMARKS This is a dead end sump. Development is not proposed as long as the lake level stays at this low point. Maximum capacity of the basin is about 300 surface acres.

There are two potholes of 50 & 60 surface acres present now at a depth of 5 feet maximum.

On the southeast side there are some big trees where there once was a homestead. ~~This would make a nice camping area.~~

LAKE AND RESERVOIR ACCESS EVALUATION

Donner and Blitzen System

Harney County Area Priority C

Name Krumbo Reservoir County Harney

Location 4 miles east of Burns-Frenchglen Highway

Township 30 S Range 32 E Sec. 19 Tax Lot No. _____

Ownership U.S. Fish and Wildlife Service Number of owners _____

DESCRIPTION

Terrain High desert - rimrocks

Cover type Sage and bunch grass

Existing access U. S. Fish and Wildlife Service

Surface acres _____ Water quality Excellent Levels Low - Summer & fall * High - Spring

Present stage of development Campground and limited boat launching facilities

* Reservoir is spring fed.

ANGLER NEEDS

Acquisition: _____ acres, _____ of frontage

Type of conveyance _____

Development:

Boat ramp: Type Improve existing gravel ramp Number of lanes _____

Toilets _____ Trails _____ Roads _____

Parking area _____; for _____ cars or _____ car-trailer units

This site will accommodate trout anglers in Harney County.

Name Krumbo Reservoir

FISHERY: Rainbow trout

	Spring	Summer	Fall	Winter
Heavy				
Medium	Tr		Tr	
Light		Tr		

(Sa - Salmon, St - Steelhead, Tr - Trout, Sg - Sturgeon, Ww - Warm Water Fishes)

SKETCH

Seasons (Check)

(See Harney County map for location)

RECREATION
(Check)

Boating, motor
 Boating, non-motor
 Camping, tent
 Camping, trailer
 Fishing, boat
 Fishing, shore
 Hiking
 Horseback riding
 Hunting, big game
 Hunting, upland game
 Hunting, waterfowl
 Nature study
 Picnicking
 Sightseeing *
 Skin and scuba diving
 Swimming
 Water skiing

	Spring	Summer	Fall	Winter
	x	x	x	
	x	x	x	
	x	x	x	
	x	x	x	
	x	x	x	

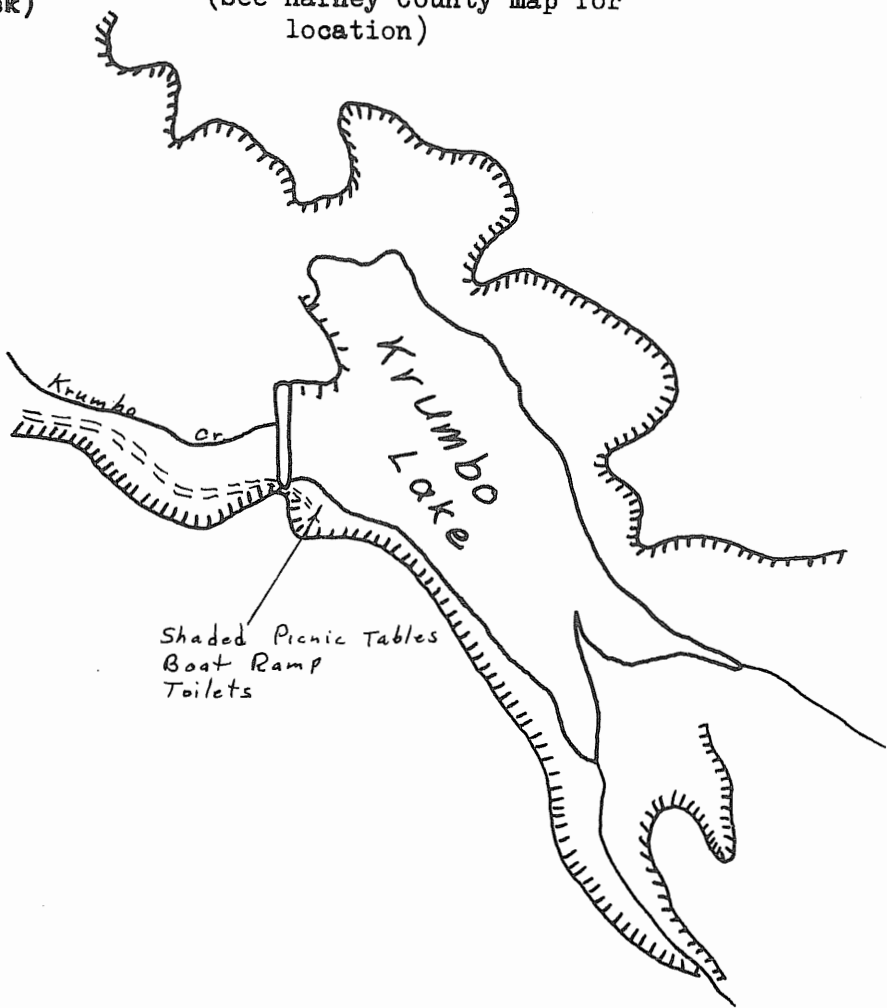

* Indian artifacts

OTHER

Safety Problems:

Group Facilities: Picnicking, camping

REMARKS The camping area could use some shade, drinking water, and general improvement. Reservoir fluctuates between 80-200 surface acres. Boat ramp could stand improvement. Hunting, except with bow and arrow for deer, is prohibited on the refuge. Krumbo Creek enters the Donner und Blitzen River at river mile 31.5. Approximately 30,000 fingerling and 4 to 8,000 legals are stocked in reservoir each year.

LAKE AND RESERVOIR ACCESS EVALUATION

Northeast Steens System
Harney County Area Priority Complete
Name Mann Lake County Harney

Location 42 miles north of Fields
Township 32 S Range 35 E Sec. 7 & 18 Tax Lot No. _____
Public on east & west sides
Ownership Private on north & south ends Number of owners 2

DESCRIPTION

Terrain Valley between steep mountains
Cover type Sagebrush and grass
Existing access County and private roads
Surface acres 100 ± Water quality Good Levels Stable
Present stage of development None

ANGLER NEEDS

Acquisition: _____ acres, _____ of frontage
Type of conveyance _____

Development:

Boat ramp: Type _____ Number of lanes _____
Toilets X Trails _____ Roads _____
Parking area _____; for _____ cars or _____ car-trailer units

This site provides a camping area for Indian artifact hunters and big game
hunters.

FISHERY: Cutthroat and rainbow trout 12" - 14"

	Spring	Summer	Fall	Winter
Heavy				
Medium				
Light	Tr	Tr	Tr	

(Sa - Salmon, Tr - Trout, Ww - Warm Water Fishes)

SKETCH

(See Harney County map for location)

Seasons (Check)

	Spring	Summer	Fall	Winter
	X	X	X	X
	X	X	X	X
	X	X	X	X
			X	
			X	X
			X	X
	X	X		

RECREATION
(Check)

- Boating, motor
- Boating, non-motor
- Camping, tent
- Camping, trailer
- Fishing, boat
- Fishing, shore
- Hiking
- Horseback riding
- Hunting, big game
- Hunting, upland game
- Hunting, waterfowl
- Nature study
- Picnicking
- Sightseeing
- Skin and scuba diving
- Swimming
- Water skiing

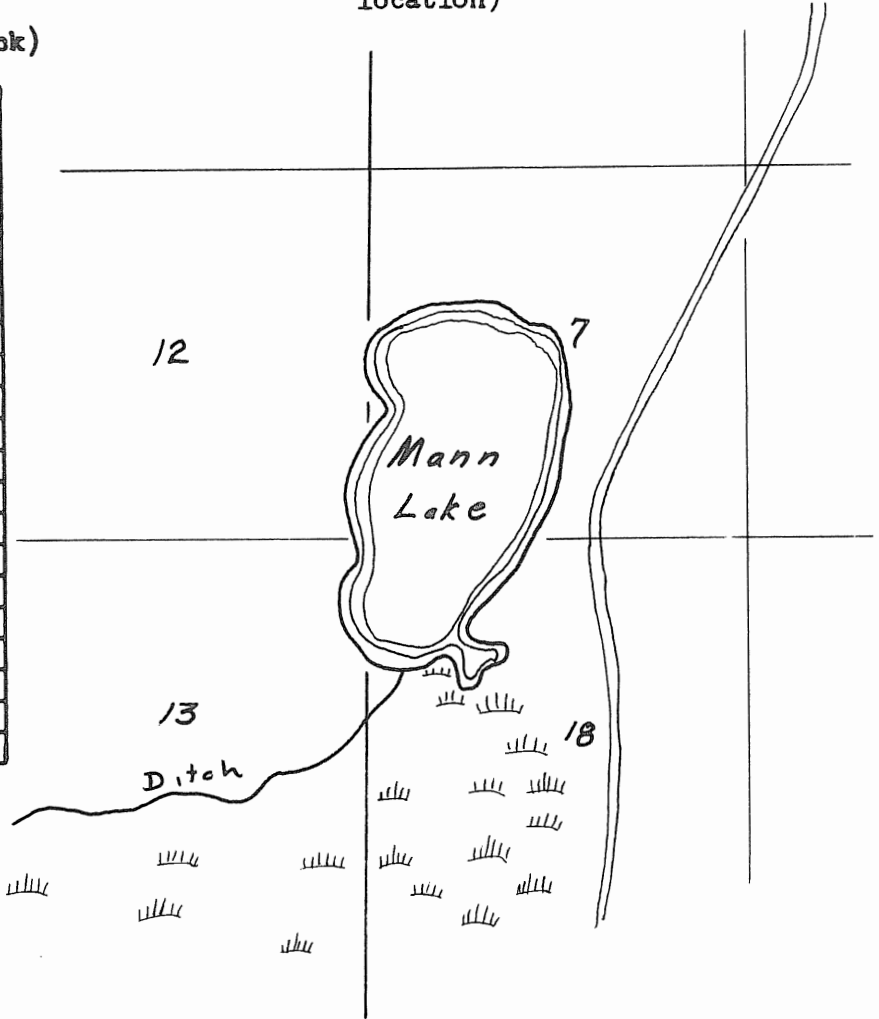

OTHER

Safety Problems:

Group Facilities:

REMARKS

This is a dead end sump. Since 1956 the lake has gradually been going dry. In 1956, it was 14 feet deep. In the last few years, it has dropped to three feet in depth. Under these conditions, no development is recommended. Many arrowhead hunters and deer hunters camp here. The maximum size of the basin is about 300 surface acres.

LAKE AND RESERVOIR ACCESS EVALUATION

Malheur System
Harney County Area Priority B
Name Miller's Reservoir County Harney

Location 14 miles west of Drewsey
Township 20 S Range 33 $\frac{1}{2}$ E Sec. 10 Tax Lot No. _____
Ownership Private Number of owners 1

DESCRIPTION

Terrain Rolling hills
Cover type Juniper and sagebrush
Existing access Private dirt road
Surface acres 36 Water quality Excellent Levels Fluctuate
A public service group constructed
Present stage of development one pit toilet.

ANGLER NEEDS

Acquisition: _____ acres, _____ of frontage
Type of conveyance Purchase reservoir

Development:

Boat ramp: Type _____ Number of lanes _____
Toilets _____ Trails _____ Roads _____
Parking area _____; for _____ cars or _____ car-trailer units

This site should be bought or brought under public control if ever possible.

FISHERY: Rainbow trout up to 14 inches.

	Spring	Summer	Fall	Winter
Heavy				
Medium		Tr		
Light			Tr	

(Sa - Salmon, Tr - Trout,
Ww - Warm Water Fishes)

SKETCH

(See Harney County map for location)

Seasons (Check)

	Spring	Summer	Fall	Winter
		X	X	

RECREATION
(Check)

- Boating, motor
- Boating, non-motor
- Camping, tent
- Camping, trailer
- Fishing, boat
- Fishing, shore
- Hiking
- Horseback riding
- Hunting, big game
- Hunting, upland game
- Hunting, waterfowl
- Nature study
- Picnicking
- Sightseeing
- Skin and scuba diving
- Swimming
- Water skiing

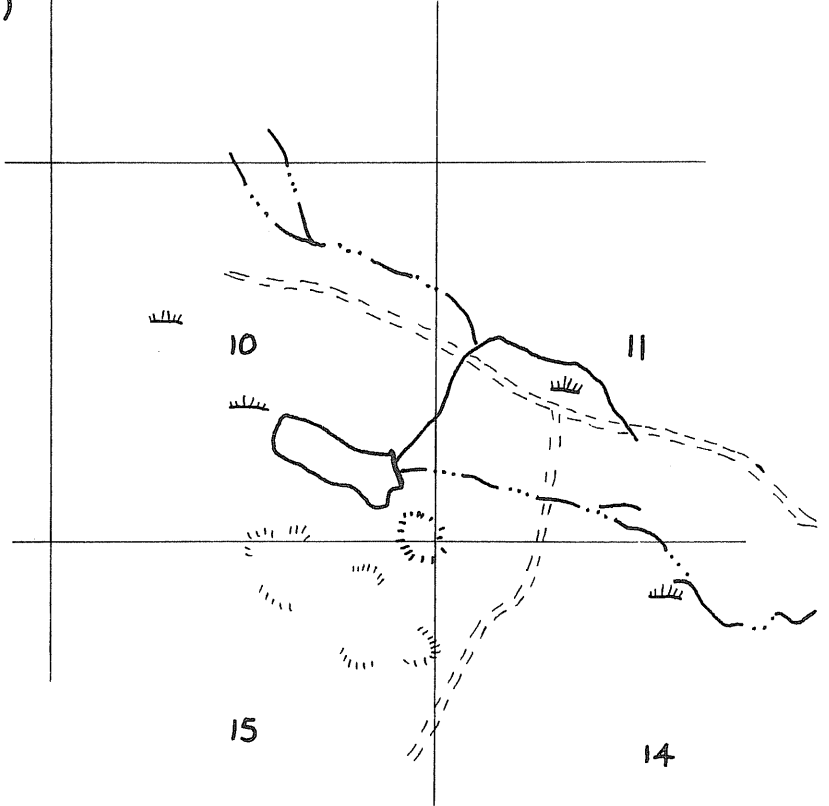

OTHER

Safety Problems:

Group Facilities:

REMARKS

This is a private lake that is limited to fishing only by the owner.

LAKE AND RESERVOIR ACCESS EVALUATION

Silver Creek System
Harney County Area Priority B
Name Moon Reservoir County Harney

Location 30 miles southwest of Burns
Township 24 & 25 S Range 27 & 28 E Sec. Many Tax Lot No. _____
Ownership BLM Number of owners _____

DESCRIPTION

Terrain Rolling hills
Cover type Sagebrush and grass
Existing access Single lane dirt road
Surface acres 540 maximum Water quality Excellent Levels Fluctuate
Present stage of development None

ANGLER NEEDS

Acquisition: _____ acres, _____ of frontage
Type of conveyance _____

Development:
Boat ramp: Type Gravel Number of lanes 1
Toilets X Trails _____ Roads X
Parking area X; for _____ cars or 30 car-trailer units

This site provides a warm-water fishery but the pool is drawn way down in
most years.

FISHERY: Largemouth bass and a few rainbow.

	Spring	Summer	Fall	Winter
Heavy				
Medium				
Light		Ww	Ww	

(Sa - Salmon, Tr - Trout,
Ww - Warm Water Fishes)

SKETCH

(See Harney County map for location)

Seasons (Check)

RECREATION
(Check)

	Spring	Summer	Fall	Winter
Boating, motor				
Boating, non-motor				
Camping, tent				
Camping, trailer				
Fishing, boat				
Fishing, shore		X	X	
Hiking				
Horseback riding				
Hunting, big game				
Hunting, upland game				
Hunting, waterfowl				
Nature study				
Picnicking				
Sightseeing				
Skin and scuba diving				
Swimming			X	
Water skiing				

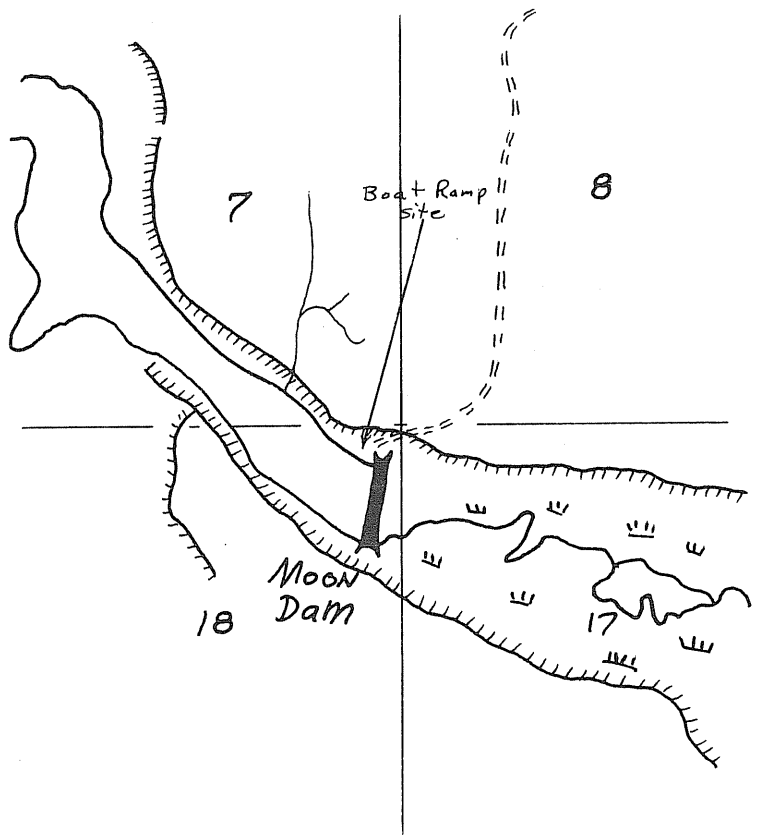

REMARKS

The road to the lake is in poor condition and the lake is infested with roach. However, the reservoir is nearly drained every year. Dam should be raised back the 8 feet that originally existed.

The U. S. Fish and Wildlife Service lowered the spillway about 8 feet to allow the high flow to go through (original pipe was too small). The U.S. Fish and Wildlife Service should raise the dam and store more water so it could be used later in the year and in turn provide a good minimum pool.

The overflow now flows into Harney Lake and dries up each summer.

LAKE AND RESERVOIR ACCESS EVALUATION

Donner und Blitzen System

Harney County Area Priority A
Name Pate Lake County Harney

Location Approximately 1/4 mile northeast of Fish Lake
Township 32 1/2 S Range 33 E Sec. 28 Tax Lot No. 4
Ownership Private Number of owners 1

DESCRIPTION

Terrain High mountain desert near summit of Steens Mountain
Cover type Sage bunchgrass with aspens and willows around lake
Existing access Public and private two-lane dirt road
Surface acres 6 + Water quality Poor Levels Levels
Present stage of development 2 garbage cans

ANGLER NEEDS

Acquisition: 5 acres on southwest corner of lake.
Perpetual easement for campground
Type of conveyance development.

Development: * Campgrounds

Boat ramp: Type _____ Number of lanes _____

Toilets X Trails _____ Road Improvement

Parking area _____; for _____ cars or _____ car-trailer units

This site will accommodate overflow campers from Fish Lake campground
(1/4 mile to Fish Lake)

* Water development and tables would enhance this area.

FISHERY: None! The lake is too shallow to support a fishery and there seems no practical way to increase the size or depth.

	Spring	Summer	Fall	Winter
Heavy				
Medium				
Light				

(Sa - Salmon, Tr - Trout, Ww - Warm Water Fishes)

SKETCH

(See Harney County map for location)

Seasons (Check)

RECREATION
(Check)

- Boating, motor
- Boating, non-motor
- Camping, tent
- Camping, trailer
- Fishing, boat
- Fishing, shore
- Hiking
- Horseback riding
- Hunting, big game
- Hunting, upland game
- Hunting, waterfowl
- Nature study
- Picnicking
- Sightseeing
- Skin and scuba diving
- Swimming
- Water skiing

	Spring	Summer	Fall	Winter
		X	X	
		X	X	
		X	X	
		X	X	
		X	X	
		X	X	
		X	X	

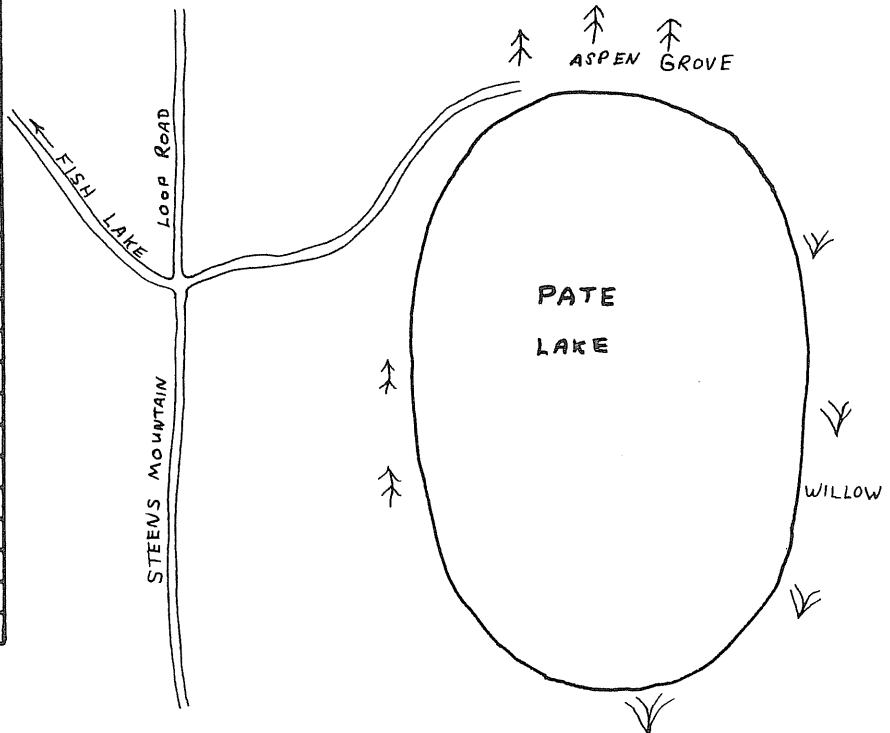

OTHER

Safety Problems:

Group Facilities: Picnicking, camping

REMARKS

The area is used heavily as a camp site by Fish Lake anglers and deer hunters.

LAKE AND RESERVOIR ACCESS EVALUATION

Malheur River System
Harney County Area Priority B
Name West Pine Creek Impoundment (Proposed) County Harney

Location At the headwaters of Pine Creek about 25 miles from Burns
Township 20 S Range 33 E Sec. 16 Tax Lot No. 2
Ownership USFS and private Number of owners 2

DESCRIPTION

Terrain Rolling mountains
Cover type Heavy stands of ponderosa pine
Existing access Private, single-lane dirt road
Surface acres 30-40 Water quality Good * Levels Stable
Present stage of development None

* Live stream flow during the entire year, minimum about 1 cfs.

ANGLER NEEDS

Acquisition: * acres, of frontage
Type of conveyance Purchase and/or easement

Development: * Adequate area for development of facilities.
Boat ramp: Type Concrete plank Number of lanes 1
Toilets X Trails Roads to boat launch
Parking area X; for cars or 25 car-trailer units

This site will provide another impoundment for production of a trout
fishery.

ANTICIPATED
FISHERY: Trout

	Spring	Summer	Fall	Winter
Heavy				
Medium				
Light				

(Sa - Salmon, Tr - Trout,
Ww - Warm Water Fishes)

SKETCH

(See Harney County map for
location)

Seasons (Check)

RECREATION
(Check)

	Spring	Summer	Fall	Winter
Boating, motor	X	X	X	
Boating, non-motor	X	X	X	
Camping, tent				
Camping, trailer				
Fishing, boat	X	X	X	
Fishing, shore	X	X	X	
Hiking				
Horseback riding				
Hunting, big game				
Hunting, upland game				
Hunting, waterfowl				
Nature study				
Picnicking				
Sightseeing				
Skin and scuba diving				
Swimming	X	X	X	
Water skiing				

OTHER

Safety Problems:

Group Facilities:

REMARKS

Dam would be earth fill 30-40 feet high and an estimated 150 feet long.
The proposed flooded area is now a meadow.

LAKE AND RESERVOIR ACCESS EVALUATION

Malheur System
Harney County Area Priority C
Name Sword's Reservoir County Harney

Location 11 miles northwest of Drewsey
Township 19 S Range 34 E Sec. 28 Tax Lot No. _____
Ownership Private Number of owners 1

DESCRIPTION

Terrain Rolling hills
Cover type Juniper, sagebrush and grass
Existing access Private dirt road
Surface acres 22 Water quality Excellent * Levels Fluctuate
Present stage of development None
* Partially spring fed.

ANGLER NEEDS

Acquisition: _____ acres, _____ of frontage
Type of conveyance Purchase reservoir

Development:

Boat ramp: Type _____ Number of lanes _____
Toilets _____ Trails _____ Roads _____
Parking area _____; for _____ cars or _____ car-trailer units

This site should be purchased or brought under public control if possible.

FISHERY: Rainbow trout up to 14"

Spring Summer Fall Winter

Heavy				
Medium				
Light				

(Sa - Salmon, Tr - Trout,
Ww - Warm Water Fishes)

SKETCH

Seasons (Check)

RECREATION
(Check)

- Boating, motor
- Boating, non-motor
- Camping, tent
- Camping, trailer
- Fishing, boat
- Fishing, shore
- Hiking
- Horseback riding
- Hunting, big game
- Hunting, upland game
- Hunting, waterfowl
- Nature study
- Picnicking
- Sightseeing
- Skin and scuba diving
- Swimming
- Water skiing

	Spring	Summer	Fall	Winter
	X	X	X	

(See Harney County map for location)

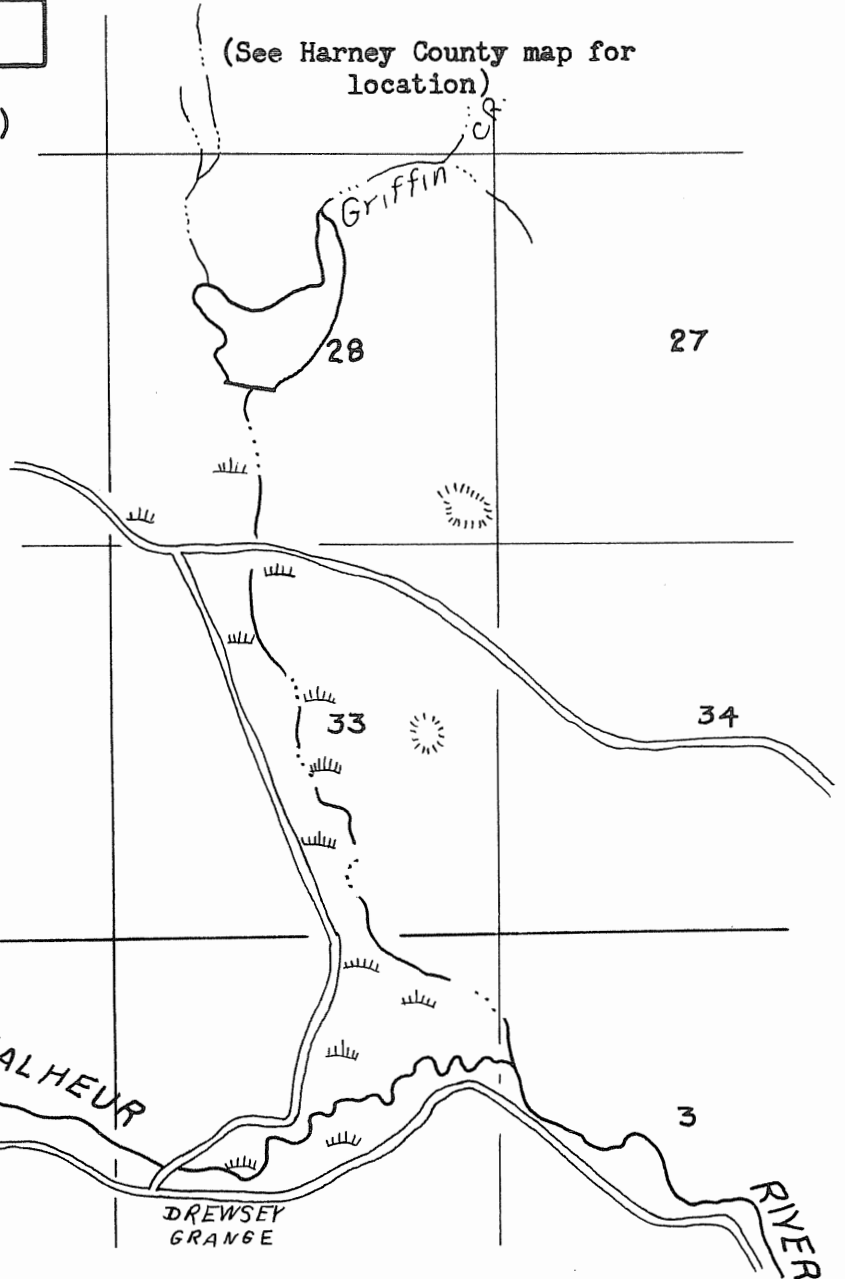

OTHER

Safety Problems:

Group Facilities:

REMARKS

The owner never stocks the reservoir, trout are all from natural reproduction. It is recommended that the reservoir be opened to public access. The owner does not allow public access without permission.

WARM SPRINGS RESERVOIR

Warm Springs Reservoir, with an area of 4,440 acres, is situated on the Middle Fork of the Malheur River in a wide canyon about five miles upstream from Riverside. The canyon is narrow at the dam, but above it broadens into a valley with steep sides on the east and gently sloping range land on the west.

The fishery in the reservoir is limited at the present time and, consequently, the angling pressure has been light. Warm-water game fish, mainly yellow perch and bluegill, make up most of the catch. The reservoir is in need of chemical treatment; this is planned by the Oregon Game Commission when a minimum pool is obtained. After treatment, rainbow, large and small-mouth bass and channel catfish fingerling will be stocked.

The main road goes along the west side of the reservoir and then heads northwest to meet Highway 20 near the Drewsy Junction.

This reservoir is in dire need of access. No developed boat ramp exists and access roads to the lake are limited and in poor condition. Two boat ramps, one for maximum pool and one for minimum pool have been recommended. Also, access roads to these ramps and access roads to the head of the reservoir have been included in this access plan.

LAKE AND RESERVOIR ACCESS EVALUATION

Malheur River System
Harney County Area Priority C
Name High-water Boat Ramp County Harney
Warm Springs Res.

Location Southwest corner of reservoir
Township 23 S Range 36 E Sec. 12 Tax Lot No. _____
Ownership Bureau of Land Management Number of owners _____

DESCRIPTION

Terrain Rolling mountains
Cover type Sagebrush and bunchgrass
Existing access None
Surface acres 4,440 Water quality Good Levels Fluctuating
Present stage of development None

ANGLER NEEDS

Acquisition: _____ acres, _____ of frontage
Type of conveyance Easement and/or purchase

Development:
Boat ramp: Type Crushed rock or concrete plank Number of lanes 1
Toilets X Trails _____ Roads Access to ramp
Parking area X; for _____ cars or 30 car-trailer units

This site will accommodate anglers on Warm Springs Reservoir.

FISHERY: Trout, yellow perch, largemouth and smallmouth bass, channel catfish,
black bullheads and bluegill.

	Spring	Summer	Fall	Winter
Heavy				
Medium				
Light	Ww	Ww	Ww	

(Sa - Salmon, Tr - Trout,
Ww - Warm Water Fishes)

SKETCH

(See Harney County map for location)

Seasons (Check)

RECREATION
(Check)

- Boating, motor
- Boating, non-motor
- Camping, tent
- Camping, trailer
- Fishing, boat
- Fishing, shore
- Hiking
- Horseback riding
- Hunting, big game 1
- Hunting, upland game 2
- Hunting, waterfowl
- Nature study
- Picnicking
- Sightseeing
- Skin and scuba diving
- Swimming
- Water skiing

	Spring	Summer	Fall	Winter
X	X			
X	X			
X	X			
X	X			
X	X	X		
X	X			

1. Pronghorn antelope
2. Chukars

OTHER

Safety Problems:

Group Facilities:

REMARKS

Fishing pressure on the reservoir has been very light because of heavy populations of perch and rough fish.

At the present time there is no development at this site.

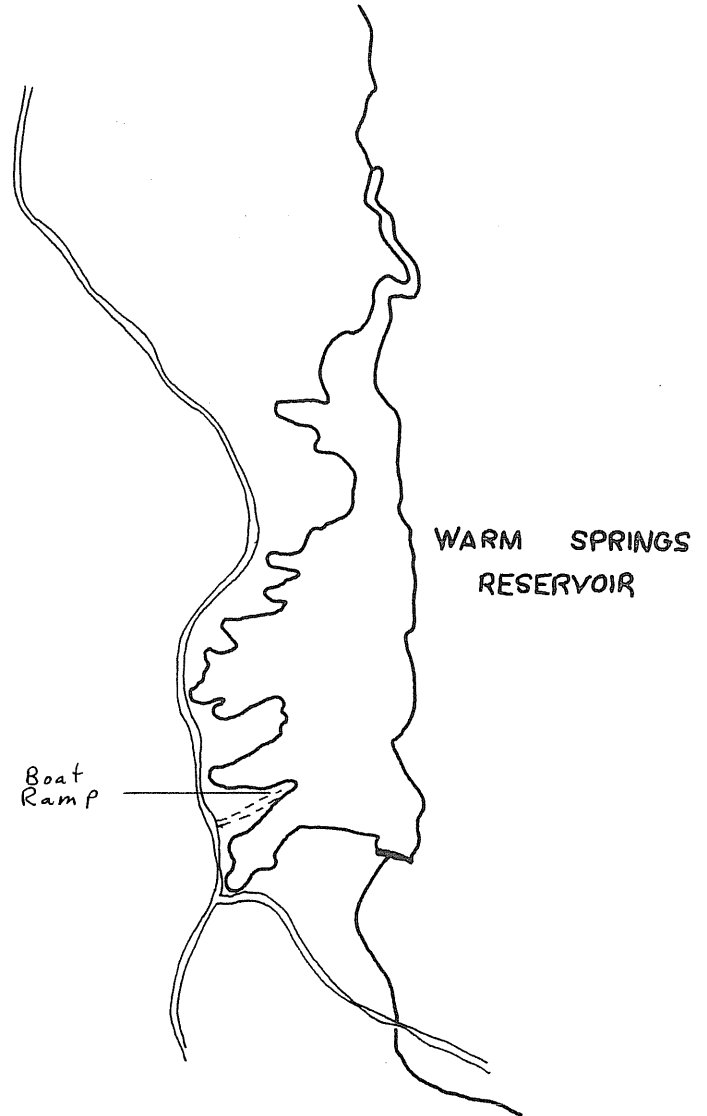

LAKE AND RESERVOIR ACCESS EVALUATION

Malheur River System
Harney County Area Priority A
Name Low Water Boat Ramp County Harney
Warm Springs Res.

Location Northwest corner of Warm Springs Reservoir, west bank
Township 22 S Range 36 E Sec. 26 Tax Lot No. _____
Ownership BLM and private Number of owners _____

DESCRIPTION

Terrain Rolling mountains
Cover type Sagebrush and bunchgrass
Existing access Single - lane dirt
Surface acres 4,440 Water quality Good Levels Fluctuating
Present stage of development Dirt road to site

ANGLER NEEDS

Acquisition: _____ acres, _____ of frontage
Type of conveyance Easement and/or purchase

Development:
Boat ramp: Type Crushed rock or concrete plank Number of lanes 1
Toilets X Trails _____ Roads Improvement
Parking area X; for _____ cars or 30 car-trailer units

This site will accommodate anglers at low water levels on Warm Springs
Reservoir.

Name Low Water Boat Ramp

FISHERY: Trout, yellow perch, largemouth and smallmouth bass, channel catfish,
black bullheads and bluegill

	Spring	Summer	Fall	Winter
Heavy				
Medium				
Light	Ww	Ww	Ww	

(Sa - Salmon, Tr - Trout,
Ww - Warm Water Fishes)

SKETCH

(See Harney County map for location)

Seasons (Check)

RECREATION
(Check)

- Boating, motor
- Boating, non-motor
- Camping, tent
- Camping, trailer
- Fishing, boat
- Fishing, shore
- Hiking
- Horseback riding
- Hunting, big game ¹
- Hunting, upland game ²
- Hunting, waterfowl
- Nature study
- Picnicking
- Sightseeing
- Skin and scuba diving
- Swimming
- Water skiing

	Spring	Summer	Fall	Winter
X	X	X		
X	X	X		
X	X	X		
X	X	X		
			X	
			X	X
X	X	X		
X	X	X		

1. Pronghorn antelope
2. Chukars

OTHER

Safety Problems:

Group Facilities:

REMARKS

This ramp would provide access to the water for boaters at all pool levels. The ramp should be about 150-foot long and provide access to the water at low minimum pool.

At the present time this site is only suitable for boat launching at nearly full reservoir.

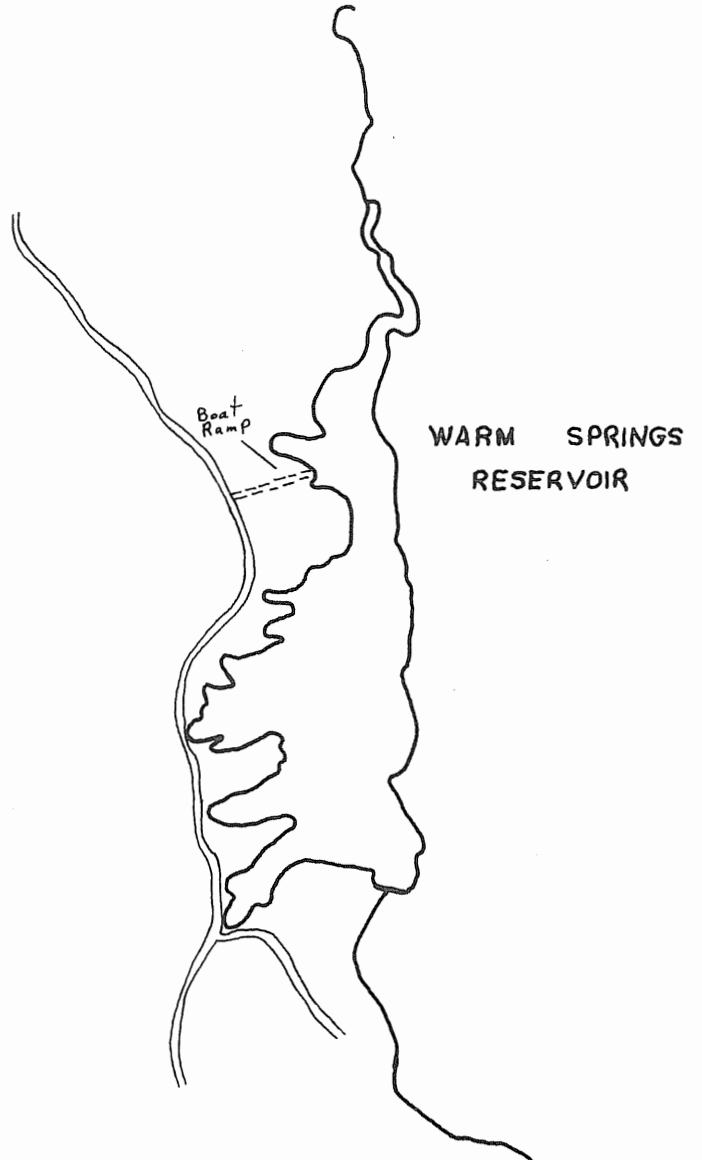

LAKE AND RESERVOIR ACCESS EVALUATION

Malheur River System
Harney County Area Priority B
Name Upper Reservoir Access Road County Harney
Warm Springs Res.

Location From Riverside-Drewsey road to head of reservoir, west bank
Township 22 S Range 36 E Sec. _____ Tax Lot No. 2
Ownership BLM and private Number of owners 2

DESCRIPTION

Terrain Rolling mountains
Cover type Sagebrush and bunchgrass
Existing access Jeep trail
Surface acres _____ Water quality Good Levels Fluctuating
Present stage of development Jeep trail

ANGLER NEEDS

Acquisition: _____ acres, _____ of frontage
Type of conveyance Easement

Development:

Boat ramp: Type _____ Number of lanes _____
Toilets _____ Trails _____ Roads _____ Construction _____
Parking area _____; for _____ cars or _____ car-trailer units

This site will accommodate warm-water game fish anglers at the head of the
reservoir and chukar hunters in the canyon above the reservoir.

FISHERY: Trout, yellow perch, largemouth and smallmouth bass, channel catfish, black bullheads, and bluegill in the reservoir; smallmouth bass and some trout and channel catfish in river.

	Spring	Summer	Fall	Winter
Heavy				
Medium				
Light	Ww	Ww	Ww	

(Sa - Salmon, Tr - Trout, Ww - Warm Water Fishes)

SKETCH

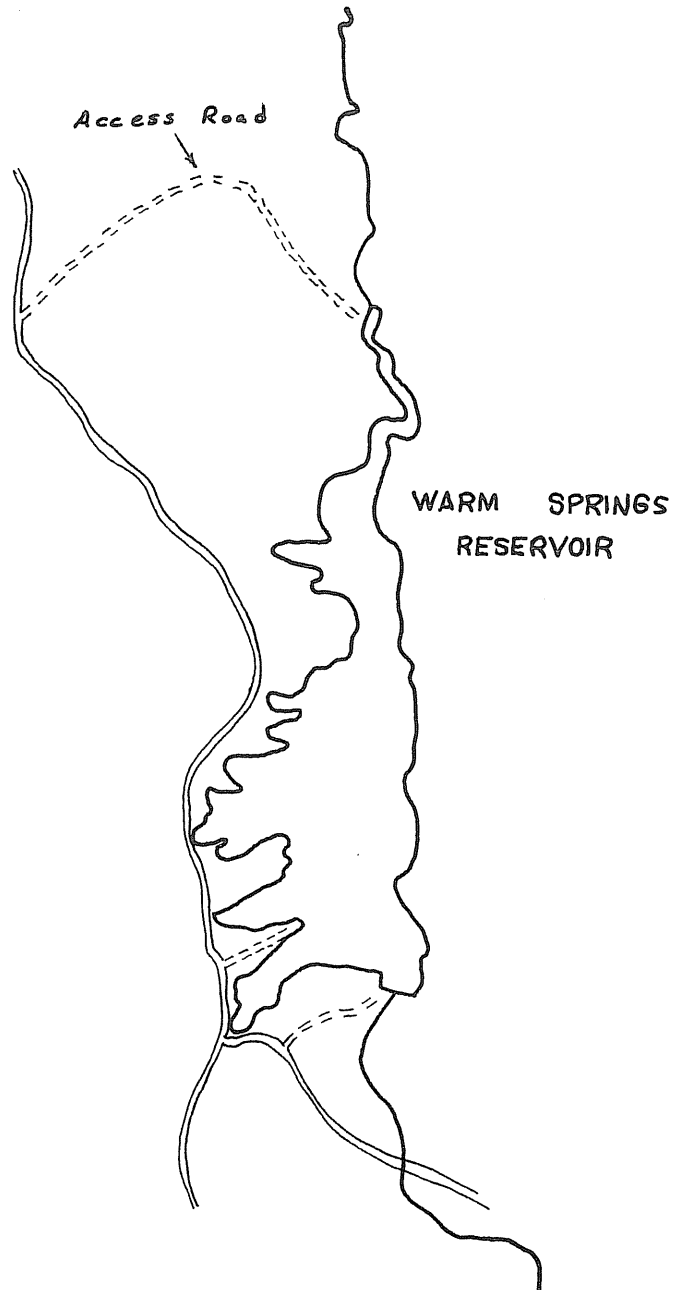

Seasons (Check)

RECREATION
(Check)

- Boating, motor
- Boating, non-motor
- Camping, tent
- Camping, trailer
- Fishing, boat
- Fishing, shore
- Hiking
- Horseback riding
- Hunting, big game 1
- Hunting, upland game 2
- Hunting, waterfowl
- Nature study
- Picnicking
- Sightseeing
- Skin and scuba diving
- Swimming
- Water skiing

	Spring	Summer	Fall	Winter
	X	X	X	
			X	
			X	X

- 1. Pringhorn antelope
- 2. Chukars

OTHER

Safety Problems:

Group Facilities:

REMARKS

This road will provide access to a remote section of the reservoir and river canyon.

LAKE AND RESERVOIR ACCESS EVALUATION

Alvord System
Harney County Area Priority B
Name Wildhorse Lake County Harney

Location 10 miles southeast of Fish Lake
Township 33 S Range 33 E Sec. 35 Tax Lot No. _____
Ownership BLM Number of owners 1

DESCRIPTION

Terrain Steep mountains
Cover type Short grass
Existing access None
Surface acres 15 Water quality Excellent Levels Stable
Present stage of development None

ANGLER NEEDS

Acquisition: _____ acres, _____ of frontage
Type of conveyance _____

Development:
Boat ramp: Type _____ Number of lanes _____
Toilets _____ Trails X Roads _____
Parking area _____; for _____ cars or _____ car-trailer units

This lake is at elevation 8,500 feet and is about 40 feet deep.

Name Wildhorse Lake

FISHERY: Cutthroat trout - there were 14" fish here in 1967.

	Spring	Summer	Fall	Winter
Heavy				
Medium				
Light		Tr	Tr	

(Sa - Salmon, Tr - Trout,
Ww - Warm Water Fishes)

SKETCH

(See Harney County map for location)

Seasons (Check)

RECREATION
(Check)

	Spring	Summer	Fall	Winter
Boating, motor				
Boating, non-motor				
Camping, tent				
Camping, trailer				
Fishing, boat				
Fishing, shore		X	X	
Hiking				
Horseback riding				
Hunting, big game			X	
Hunting, upland game			X	X
Hunting, waterfowl				
Nature study				
Picnicking				
Sightseeing		X	X	
Skin and scuba diving				
Swimming				
Water skiing				

OTHER

Safety Problems:

Group Facilities:

REMARKS

It is about a 1/2 mile walk into the lake. It is situated near the summit of the Steens Mountain. The establishment of a trail over the first 200 yards from the road would enable more people to get to the lake.

LAKE AND RESERVOIR ACCESS EVALUATION

Silvies System
Harney County Area Priority Under development
Name Yellowjacket Lake County Harney

Location 37 miles northwest of Burns
Township 19 S Range 29 E Sec. 32 Tax Lot No. _____
Ownership Oregon State Game Commission Number of owners 1

DESCRIPTION

Terrain Rolling mountains
Cover type Pine, juniper and sagebrush
Existing access Single-lane dirt road
Surface acres 34 Water quality Excellent Levels Stable
Present stage of development Under development

ANGLER NEEDS

Acquisition: _____ acres, _____ of frontage
Type of conveyance _____

Development:

Boat ramp: Type _____ Number of lanes _____
Toilets _____ Trails _____ Roads _____
Parking area _____; for _____ cars or _____ car-trailer units

This site will have a boat ramp, campground and new road built by the
Forest Service. Toilets have already been erected on the west
side of the lake.

FISHERY: Rainbow trout and kokanee

Spring Summer Fall Winter

Heavy				
Medium	Tr	Tr	Tr	
Light				

(Sa - Salmon, Tr - Trout, Ww - Warm Water Fishes)

SKETCH

(See Harney County map for location)

Seasons (Check)

RECREATION
(Check)

	Spring	Summer	Fall	Winter
Boating, motor	X	X	X	
Boating, non-motor	X	X	X	
Camping, tent	X	X	X	
Camping, trailer	X	X	X	
Fishing, boat	X	X	X	
Fishing, shore	X	X	X	
Hiking	X	X	X	
Horseback riding				
Hunting, big game *			X	
Hunting, upland game				
Hunting, waterfowl				
Nature study				
Picnicking	X	X	X	
Sightseeing				
Skin and scuba diving				
Swimming	X	X	X	
Water skiing				

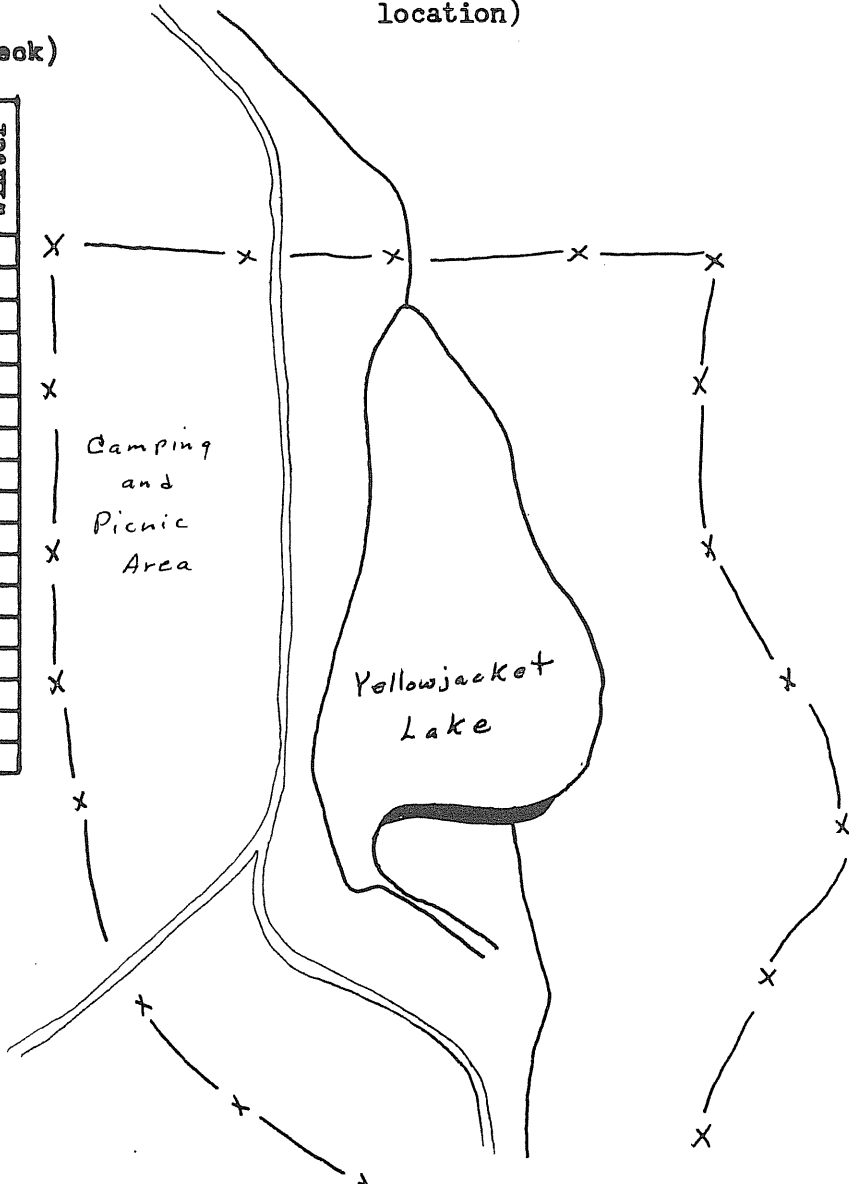

* Deer & elk

OTHER

Safety Problems:

Group Facilities:

REMARKS

It is planned to put this lake on a regulation basis, open in April and closed in October. The Forest Service is planning a new road along the hill to the west side of the lake which would improve access. It is possible that the dam may be raised in the future.

MALHEUR COUNTY LAKES

This area includes all the lakes in Malheur County. Most of these lakes are man made reservoirs ranging in size from Owyhee Reservoir, which contains 12,000 surface acres and is 40 miles long, to tiny South Cottonwood Reservoir which covers only 2 acres.

Malheur County is a long, narrow county that extends from the Nevada border to the southern edge of the Elkhorn Mountains. The southern two-thirds of the county is quite unpopulated and desolate. Cattle graze over the sagebrush flats and hillsides, and a few small valleys are irrigated for growing hay for winter feed. Much of the topography is rugged with streams flowing in deep rimrock bordered canyons. Access roads are limited and in most cases are only for dry weather travel.

The area around Vale and Ontario has been developed for agriculture. Five large reservoirs provide the irrigation for sugar beets, potatoes, corn, and hay. The surrounding mountains are bare, or have only scattered stands of juniper and sagebrush.

The lakes of the county are more fully described in this section. In some instances the construction of a potential impoundment is proposed and on a few of the established reservoirs a guaranteed minimum pool is needed to maintain a fishery. On the remaining lakes, development of a recreational facility is recommended if the existing facility is not adequate.

The following sections and site evaluation forms explain in detail the sites and recommended development.

LAKE AND RESERVOIR ACCESS EVALUATION

Owyhee System
Malheur County Area Priority A
Name Antelope Reservoir County Malheur

Location 12 miles west of Jordan Valley
Township 30 & 31 S Range 45 E Sec. Many Tax Lot No. _____
Ownership BLM Number of owners _____

DESCRIPTION

Terrain Rolling hills and alkali flats
Cover type Grass and sagebrush
Existing access Single-lane dirt road
Surface acres 3000+ Water quality Good Levels Fluctuate
Present stage of development None

ANGLER NEEDS

Acquisition: _____ acres, _____ of frontage
Type of conveyance _____
Development: Campground
Boat ramp: Type Gravel Number of lanes 2
Toilets X Trails _____ Roads _____
Parking area X; for _____ cars or 50 car-trailer units

This lake provides an excellent trout fishery.

FISHERY: Rainbow trout - fingerling fish were stocked in February and by September the trout were up to 10-11 inches.

	Spring	Summer	Fall	Winter
Heavy				
Medium				
Light	Tr	Tr	Tr	

(Sa - Salmon, Tr - Trout, Ww - Warm Water Fishes)

SKETCH

Seasons (Check)

RECREATION -if (Check) developed

	Spring	Summer	Fall	Winter
Boating, motor	X	X	X	
Boating, non-motor	X	X	X	
Camping, tent	X	X	X	
Camping, trailer	X	X	X	
Fishing, boat	X	X	X	
Fishing, shore				
Hiking				
Horseback riding				
Hunting, big game			X	
Hunting, upland game			X	X
Hunting, waterfowl			X	X
Nature study				
Picnicking	X	X	X	
Sightseeing				
Skin and scuba diving				
Swimming	X	X	X	
Water skiing		X	X	

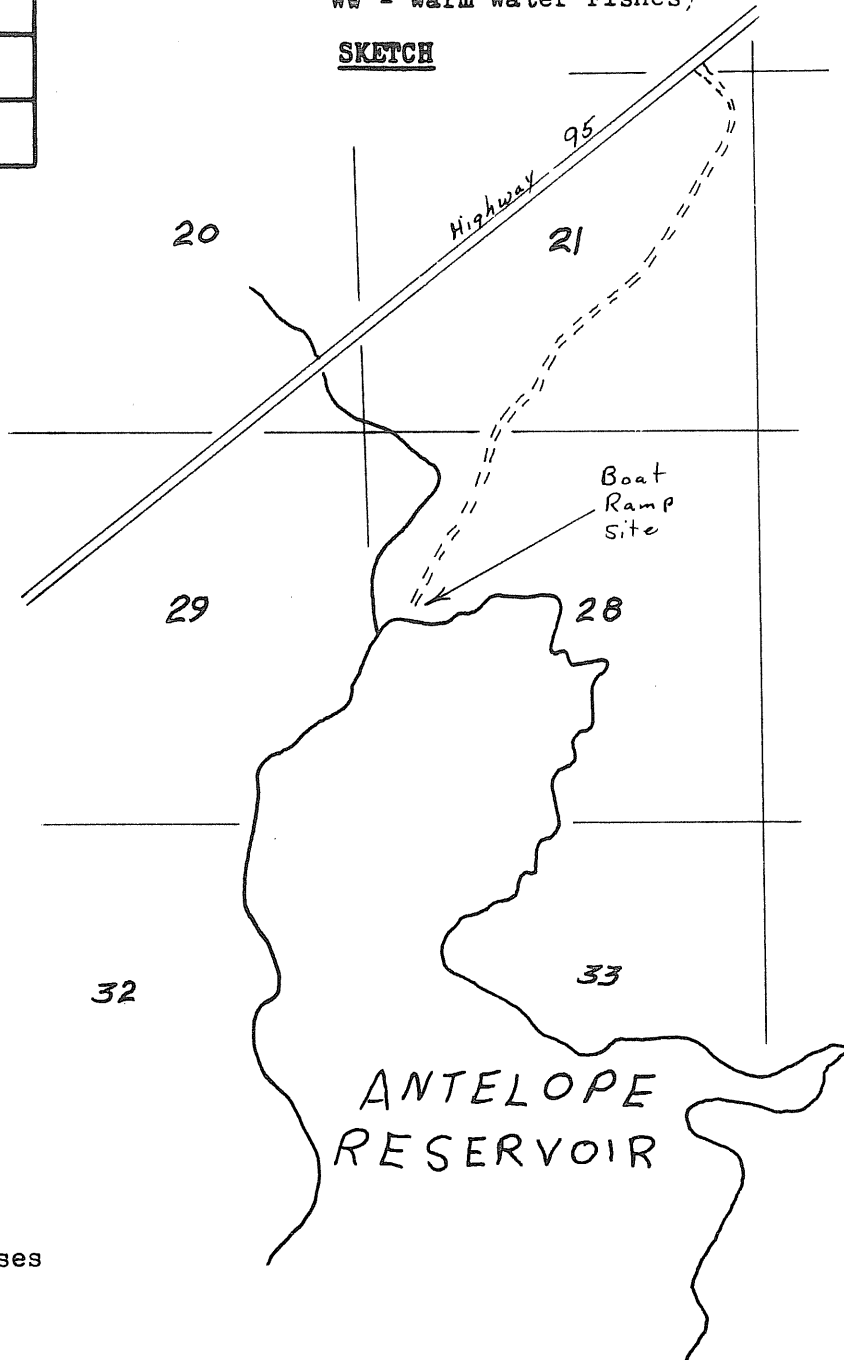

OTHER

Safety Problems:

Group Facilities: Parking for buses

REMARKS

This is one of the best reservoirs in southeastern Oregon as far as fish growth is concerned. The development of a campground would be good since the lake is getting more use every year.

LAKE AND RESERVOIR ACCESS EVALUATION

Owyhee System
Malheur County Area Priority C
Name Batch Lake County Malheur

Location 2 miles west of Cow Lakes
Township 28 & 29 S Range 44 E Sec. 31 & 6 Tax Lot No. _____
Ownership BLM Number of owners _____

DESCRIPTION

Terrain Lava flows
Cover type None
Existing access Poor single-lane dirt road
Surface acres 50 ± Water quality Good Levels Stable
Present stage of development None

ANGLER NEEDS

Acquisition: _____ acres, _____ of frontage
Type of conveyance _____

Development:

Boat ramp: Type _____ Number of lanes _____
Toilets _____ Trails _____ Road Improvement
Parking area _____; for _____ cars or _____ car-trailer units

This lake would support a warm-water fishery and it is a good waterfowl area.

FISHERY: Perch and bullheads. The Game Commission has tentative plans to treat the lake and plant warm-water fish.

	Spring	Summer	Fall	Winter
Heavy				
Medium				
Light				

(Sa - Salmon, Tr - Trout, Ww - Warm Water Fishes)

SKETCH

Seasons (Check)

	Spring	Summer	Fall	Winter

RECREATION
(Check)

- Boating, motor
- Boating, non-motor
- Camping, tent
- Camping, trailer
- Fishing, boat
- Fishing, shore
- Hiking
- Horseback riding
- Hunting, big game
- Hunting, upland game
- Hunting, waterfowl
- Nature study
- Picnicking
- Sightseeing
- Skin and scuba diving
- Swimming
- Water skiing

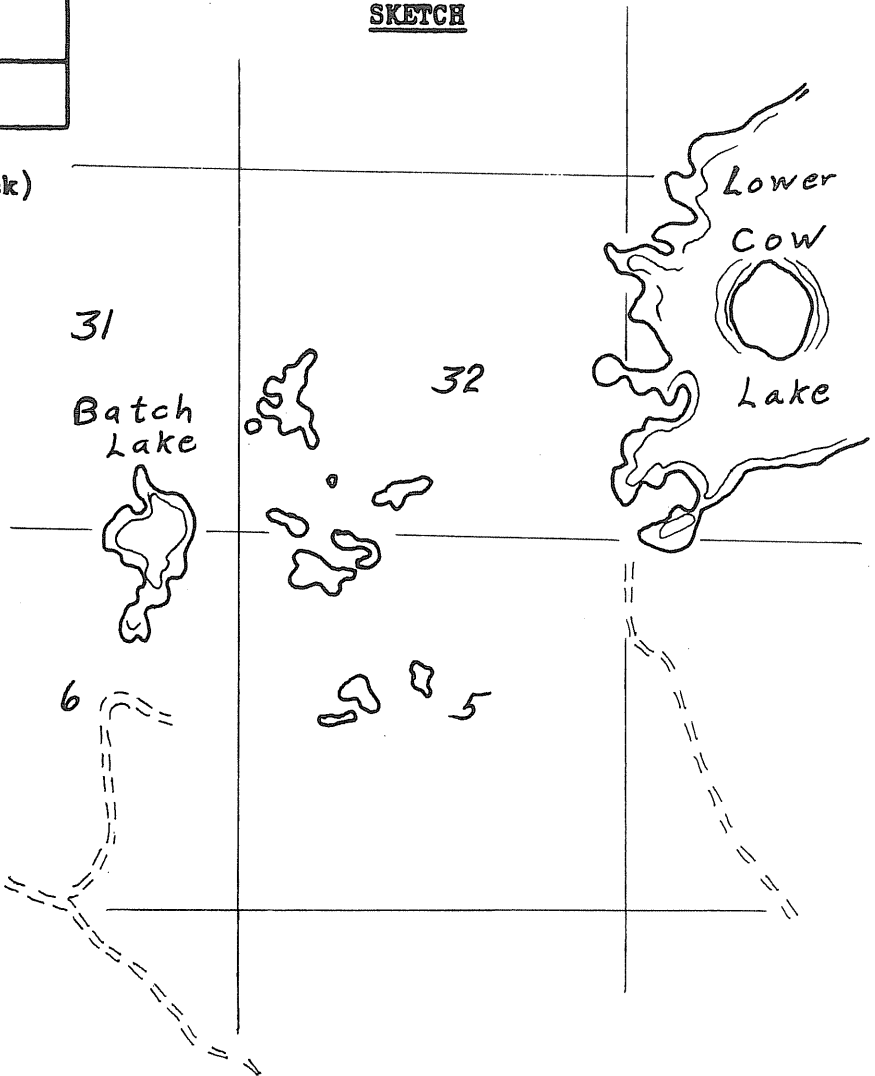

REMARKS:

The lake is only about 6 - 7 feet deep but is spring fed. It is a good waterfowl area with many potholes in the vicinity. Batch Lake was included in a public recreation area proposed for the "craters" lava flow area.

Batch Lake, and the numerous smaller ponds adjacent to the lake are under study for a "Natural Area" classification. This area is unique due to its location within a recent lava flow. As a "Natural Area", public use would be discouraged and no recreation developments would be allowed.

BEULAH RESERVOIR

Beulah Reservoir is situated on the North Fork of the Malheur River 15 miles upstream from Juntura. It covers 1,905 surface-acres and holds 60,000 acre-feet of storage. It is drawn down about half for irrigation in normal years; in a dry year it could be drained completely.

The reservoir is stocked annually with approximately 100,000 rainbow fingerling. In some years stocking rates are higher depending on lake conditions. In 1965 an estimated 6,000 anglers visited the lake and averaged 2 fish per angler. The fish ranged from 6 to 20 inches with the majority 8 to 12 inches.

A high and low water boat ramp exists adjacent to the dam and sanitary facilities are provided. Above the boat ramp along the east shore line there is a shore angling access area with toilets and trash cans. This location is used for camping and quite heavily during certain times of the year. Where the main road goes around the northeast point of the reservoir there is a hot spring and a shower has been constructed to utilize the hot water. This area is used extensively by hunters, anglers, and campers through the spring, summer, and fall. A high-water shore angling area and camping site is located at the north end of the reservoir that is maintained by Malheur County.

At the head of the reservoir on the North Fork there is a large level area where the stream is bordered by willows. The road access to the area is over private land and has been threatened to be closed off by the owner. Since this area is used lightly for camping now, it would be used more extensively if sanitary facilities were provided. A perpetual easement should be obtained to insure future access.

Murphy Reservoir is situated on Bendier Creek about 5 miles by road above Beulah Reservoir. It is stocked with 5,000 rainbow fingerling each year. Irrigation drawdown is about half each year; consequently, angling is only fair and angler use only light.

The road to the lake is extremely rough which also limits angler use. Road improvement would be desirable.

LAKE AND RESERVOIR ACCESS EVALUATION

Malheur River System
Malheur County Area Priority B
Name Beulah Reservoir Park County Malheur

Location Below Beulah Dam, east bank
Township 19 S Range 37 E Sec. 15 Tax Lot No. 100
Ownership Private Number of owners 1

DESCRIPTION

Terrain Rolling mountains
Cover type Sagebrush, bunch grass, and juniper
Existing access County two-lane gravel
Surface acres _____ Water quality Good Levels Fluctuating
Present stage of development Gravel road below dam

ANGLER NEEDS

Acquisition: 5 acres, 500 feet of frontage
Type of conveyance Purchase

Development:

Boat ramp: Type _____ Number of lanes _____
Toilets X Trails _____ Roads _____
Parking area X; for 30 cars or _____ car-trailer units

This site will accommodate trout anglers on Beulah Reservoir and on the
North Fork below the reservoir.

FISHERY: Rainbow trout - in cold years some people do a little bit of ice fishing.

	Spring	Summer	Fall	Winter
Heavy				
Medium	Tr		Tr	
Light		Tr		Tr

(Sa - Salmon, Tr - Trout,
Ww - Warm Water Fishes)

SKETCH

Seasons (Check)

RECREATION
(Check)

- Boating, motor
- Boating, non-motor
- Camping, tent
- Camping, trailer
- Fishing, boat
- Fishing, shore
- Hiking
- Horseback riding
- Hunting, big game
- Hunting, upland game
- Hunting, waterfowl
- Nature study
- Picnicking
- Sightseeing
- Skin and scuba diving
- Swimming
- Water skiing

	Spring	Summer	Fall	Winter
X	X	X		
X	X	X		
X	X	X		
X	X	X		
X	X	X		
			X	
			X	
			X	
X	X	X		
		X	X	
		X	X	

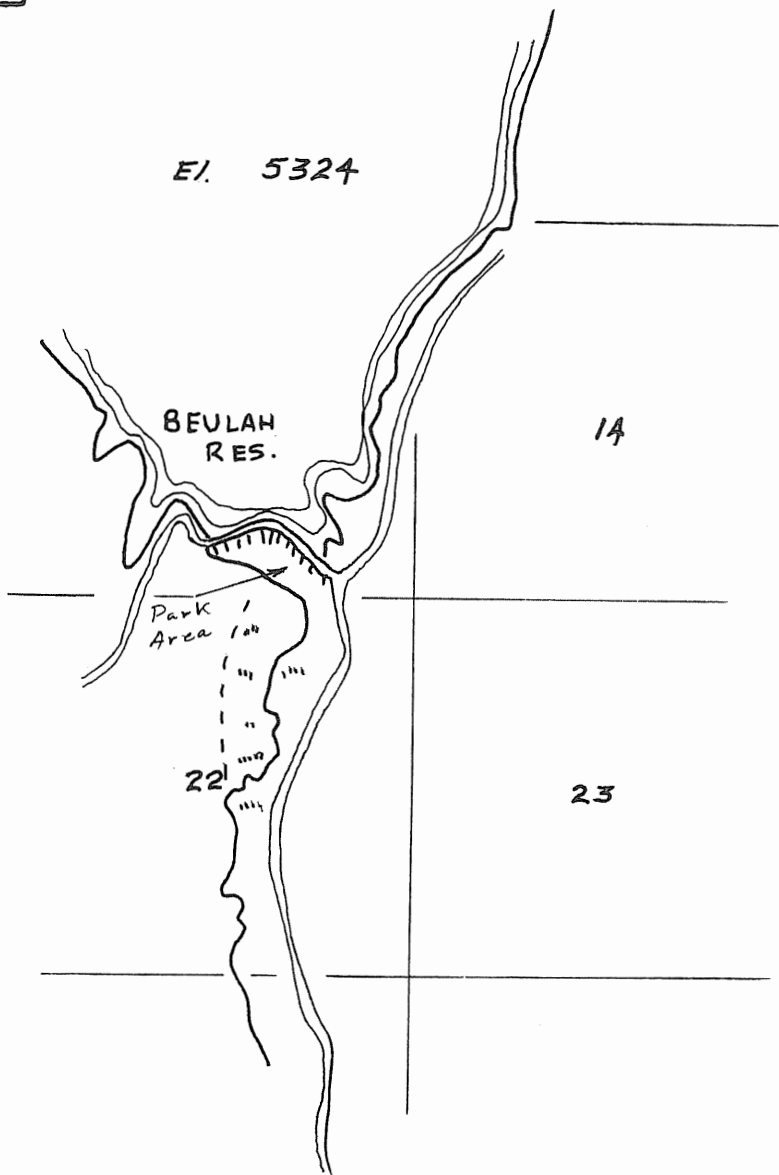

OTHER

Safety Problems:

Group Facilities:

REMARKS

The region below the dam is ideal for a beautiful park - everything is green. The area at the boat ramp is dry. Domestic water and shade trees would enhance the ramp area. The camping site at the ramp is used heavily by deer and chukar hunters.

LAKE AND RESERVOIR ACCESS EVALUATION

Malheur River System
Malheur County Area Priority B
Name Head of Beulah Reservoir County Malheur

Location At mouth of North Fork where it joins the reservoir, north bank
Township 19 S Range 37 E Sec. 3 Tax Lot No. 400
Ownership U. S. Government and private Number of owners 2

DESCRIPTION

Terrain Rolling mountains
Cover type Juniper, sagebrush and bunch grass
Existing access County single-lane dirt
Surface acres _____ Water quality Good Levels _____
Present stage of development None

ANGLER NEEDS

* Acquisition: 5 acres, 500 feet of frontage
Type of conveyance Purchase

Development:

Boat ramp: Type _____ Number of lanes _____
Toilets X Trails _____ Roads Improvement
Parking area X; for 20 cars or _____ car-trailer units

This site will accommodate trout anglers at the head of the reservoir and
and for hunter camps in the fall.

* Land should be purchased to make a camping area; a perpetual easement should be obtained to insure access to the camping area.

LAKE AND RESERVOIR ACCESS EVALUATION

Malheur River System
Malheur County Area Priority C
Name Murphy Reservoir County Malheur

Location 5 miles north of Beulah Reservoir
Township 18 S Range 38 E Sec. 17 & 20 Tax Lot No. 1300
Ownership BLM and private Number of owners 2

DESCRIPTION

Terrain Rolling mountains
Cover type Sagebrush, bunch grass and juniper
Existing access Private * - Public permitted
Surface acres _____ Water quality Good Levels High - Spring
Low - Summer & fall
Present stage of development None

* The road goes over private land, but public access is not denied.

ANGLER NEEDS

Acquisition: _____ acres, _____ of frontage
Type of conveyance _____

Development:

Boat ramp: Type _____ Number of lanes _____
Toilets _____ Trails _____ Road Improvement * _____
Parking area _____; for _____ cars or _____ car-trailer units

This site This road improvement will facilitate access to the reservoir.

* Improve the existing road so cars can easily reach the reservoir.

BULLY CREEK RESERVOIR

Bully Creek Reservoir is located on Bully Creek about nine miles west of Vale. Surface area at active capacity is 1,000 acres with total storage of 31,000 acre-feet.

Bully Creek Dam was completed in May, 1963. Chemical treatment of the impoundment occurred in October, 1963. Initial stocking of rainbow fingerling was completed in November, 1963 and by early June, 1964---8 to 10-inch fish were being caught by anglers. Since the treatment and initial stocking, 100,000 rainbow fingerling have been stocked each year.

The Bully Creek drainage lies in open, rolling, sagebrush and juniper-covered hill country with frequent valleys of cultivated lands interspersed between deep canyons and rocky draws. Many of the tributary streams are small; either going completely dry each year, running intermittently, or at best carrying small flows through most of the summer and fall. The drainage incurs occasional flash floods in the early spring which have scoured many of the stream channels.

The reservoir has one good access site that is located near the dam on the east side. A good boat ramp, running water, restrooms with showers, and camp sites have been provided; lawn and shade trees have been planted.

A warm spring is located near the head end of the impoundment. Large trees are already established that would make this site a natural for a camping area.

LAKE AND RESERVOIR ACCESS EVALUATION

Malheur River System
Malheur County Area Priority Complete
Name Bully Creek Reservoir Recreation Site County Malheur

Location Nine miles west of Vale
Township 18 S Range 43 E Sec. 12 Tax Lot No. _____
Ownership Bureau of Reclamation Number of owners _____

DESCRIPTION

Terrain Rolling mountains - level on east side of reservoir
Cover type Sagebrush and bunch grass
Existing access County two-lane gravel
Surface acres 980 Water quality Good Levels Fluctuating
Present stage of development Complete

ANGLER NEEDS

Acquisition: _____ acres, _____ of frontage
Type of conveyance _____

Development:

Boat ramp: Type _____ Number of lanes _____

Toilets _____ Trails _____ Roads _____

Parking area _____; for _____ cars or _____ car-trailer units

This site will accommodate trout anglers, and chukar and deer hunters in the
Bully Creek drainage.

FISHERY: Trout and yellow perch

	Spring	Summer	Fall	Winter
Heavy				
Medium	Tr		Tr	
Light		Tr		Tr

(Sa - Salmon, Tr - Trout,
 Ww - Warm Water Fishes)

SKETCH

(See Malheur County map for
 location)

Seasons (Check)

RECREATION
 (Check)

	Spring	Summer	Fall	Winter
Boating, motor				
Boating, non-motor				
Camping, tent	X	X	X	
Camping, trailer	X	X	X	
Fishing, boat				
Fishing, shore	X	X	X	
Hiking				
Horseback riding				
Hunting, big game			X	
Hunting, upland game			X	
Hunting, waterfowl			X	X
Nature study				
Picnicking	X	X	X	
Sightseeing				
Skin and scuba diving				
Swimming		X	X	
Water skiing		X	X	

OTHER

Safety Problems:

Group Facilities: Picnicking, camping, parking for buses

REMARKS

This recreation site is large but facilities are limited. No shade trees have been established but trees have been planted. Showers are provided at rest rooms.

LAKE AND RESERVOIR ACCESS EVALUATION

Malheur River System
Malheur County Area Priority C
Name Bully Creek Spring County Malheur

Location Twelve miles west of Vale at the upper end of the
Bully Creek Reservoir North Bank
Township 18 S Range 43 E Sec. 4 Tax Lot No. 200,201
Ownership Private Number of owners 1

DESCRIPTION

Terrain Mountainous - at head end of reservoir
Cover type Sage and bunch grass - locust trees at spring
Existing access County single-lane gravel
Surface acres 980 Water quality Good Levels Fluctuating
Present stage of development None

ANGLER NEEDS

Acquisition: _____ acres, _____ of frontage

Type of conveyance _____

Development: *

Boat ramp: Type _____ Number of lanes _____

Toilets X Trails _____ Roads _____

Parking area _____; for 20 cars or _____ car-trailer units

This site will accommodate anglers on the upper end of Bully Creek Reservoir,
and chukar and deer hunters on upper Bully Creek.

* Area should be fenced to keep cattle away from spring. A tank should be set in spring to keep water clean.

Bully Creek
 Name Spring

FISHERY: Trout angling on upper end of reservoir in early spring. This end
 of reservoir goes dry by late July in a normal year.

	Spring	Summer	Fall	Winter
Heavy				
Medium	Tr		Tr	
Light		Tr		Tr

(Sa - Salmon, Tr - Trout,
 Ww - Warm Water Fishes)

SKETCH

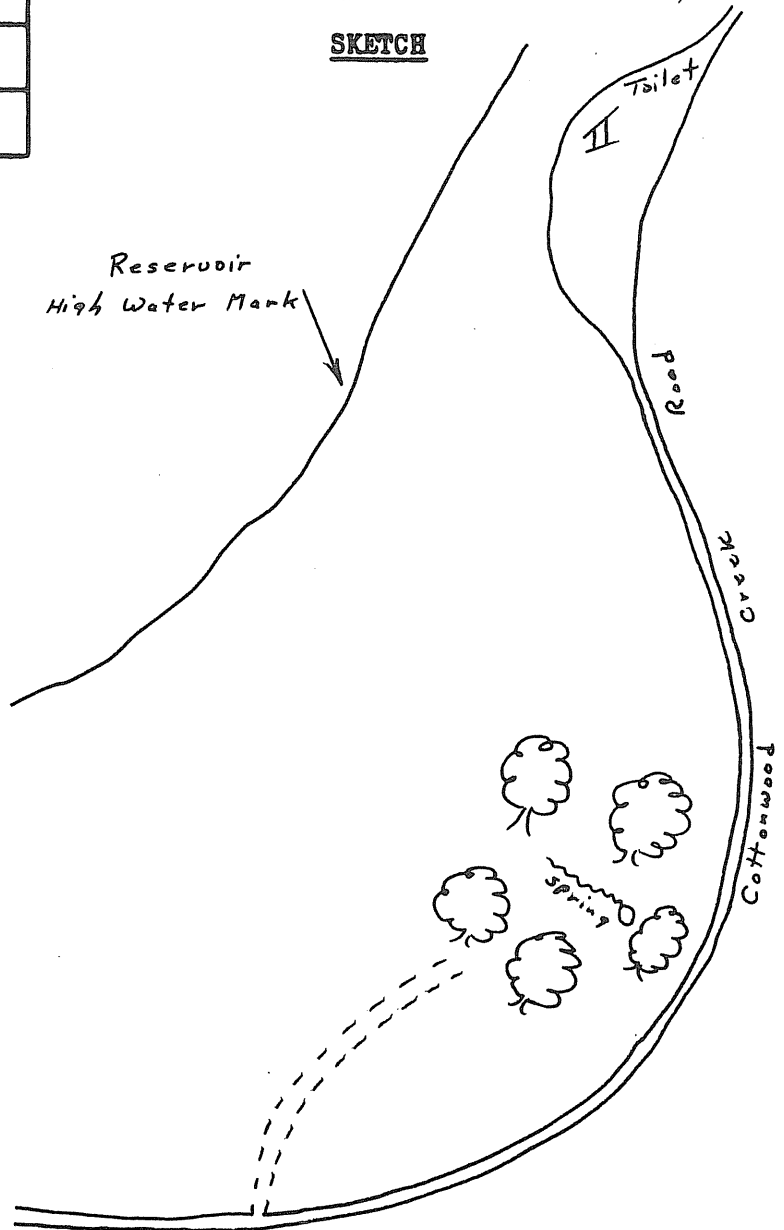

Seasons (Check)

RECREATION
 (Check)

- Boating, motor
- Boating, non-motor
- Camping, tent
- Camping, trailer
- Fishing, boat
- Fishing, shore
- Hiking
- Horseback riding
- Hunting, big game
- Hunting, upland game
- Hunting, waterfowl
- Nature study
- Picnicking
- Sightseeing
- Skin and scuba diving
- Swimming
- Water skiing

	Spring	Summer	Fall	Winter
	X	X	X	
	X	X	X	
	X	X	X	
			X	
			X	X
			X	
	X	X	X	

OTHER

Safety Problems:

Group Facilities: Picnicking, camping

REMARKS

This spring is warm, 91° in August, and shaded area of about an acre would provide a location for a nice camping spot. Area is heavily used by cattle.

LAKE AND RESERVOIR ACCESS EVALUATION

Malheur System
Malheur County Area Priority Complete
Name South Cottonwood Reservoir County Malheur

Location 15 miles west of Harper
Township 19 S Range 40 E Sec. 32 Tax Lot No. _____
Ownership Bureau of Land Management Number of owners 1

DESCRIPTION

Terrain Rolling mountains
Cover type Juniper, sagebrush and bunch grass
Existing access Single-lane dirt road (unimproved)
Surface acres 2 Water quality Good Levels Stable
Present stage of development None

ANGLER NEEDS

Acquisition: _____ acres, _____ of frontage
Type of conveyance _____

Development:

Boat ramp: Type _____ Number of lanes _____
Toilets _____ Trails _____ Roads _____
Parking area _____; for _____ cars or _____ car-trailer units

This reservoir provides a minor trout fishery.

FISHERY: Trout

	Spring	Summer	Fall	Winter
Heavy				
Medium				
Light	Tr	Tr	Tr	

(Sa - Salmon, Tr - Trout,
Ww - Warm Water Fishes)

SKETCH

(See Malheur County map for location)

Seasons (Check)

RECREATION
(Check)

	Spring	Summer	Fall	Winter
Boating, motor				
Boating, non-motor				
Camping, tent	X	X	X	
Camping, trailer				
Fishing, boat				
Fishing, shore	X	X	X	
Hiking				
Horseback riding				
Hunting, big game			X	
Hunting, upland game				
Hunting, waterfowl				
Nature study				
Picnicking				
Sightseeing				
Skin and scuba diving				
Swimming		X	X	
Water skiing				

OTHER

Safety Problems:

Group Facilities:

REMARKS

This is a very small lake that is fished only very lightly throughout the season. Hunters use the area for camping.

LAKE AND RESERVOIR ACCESS EVALUATION

Owyhee System
Malheur County Area Priority Complete
Name Cow Lakes County Malheur

Location 31 miles northwest of Jordan Valley
Township 28 S Range 44 E Sec. Many Tax Lot No. _____
Ownership BLM Number of owners _____

DESCRIPTION

Terrain Rolling hills
Cover type Rocky with sagebrush and grass
Existing access Single-lane public gravel road
Surface acres * Water quality Good Levels Stable
Present stage of development BLM campground and boat ramp at the upper lake

* Upper Lake - 975 A.
Lower Lake - 360 A. maximum

ANGLER NEEDS

Acquisition: _____ acres, _____ of frontage
Type of conveyance _____

Development:

Boat ramp: Type _____ Number of lanes _____
Toilets _____ Trails _____ Roads _____
Parking area _____; for _____ cars or _____ car-trailer units

This lake has excellent trout growing potential but now is infested with
suckers and shiners.

FISHERY: Rainbow trout

	Spring	Summer	Fall	Winter
Heavy				
Medium				
Light	Tr	Tr	Tr	

(Sa - Salmon, Tr - Trout, Ww - Warm Water Fishes)

SKETCH

Seasons (Check)

RECREATION
(Check)

	Spring	Summer	Fall	Winter
Boating, motor	x	x	x	
Boating, non-motor	x	x	x	
Camping, tent	x	x	x	
Camping, trailer	x	x	x	
Fishing, boat	x	x	x	
Fishing, shore	x	x	x	
Hiking				
Horseback riding				
Hunting, big game			x	
Hunting, upland game			x	
Hunting, waterfowl			x	
Nature study				
Picnicking				
Sightseeing			x	
Skin and scuba diving				
Swimming			x	
Water skiing				

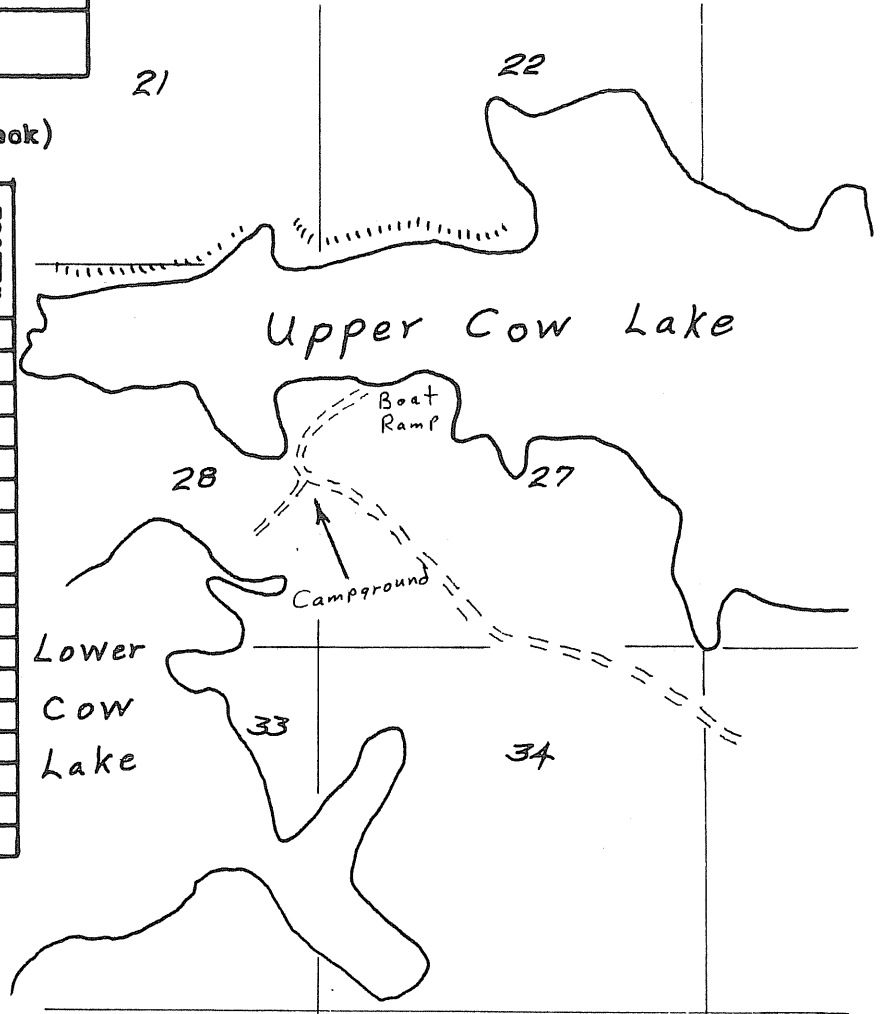

OTHER

Safety Problems:

Group Facilities:

REMARKS

These lakes are located just to the east of "the craters", a lava flow and rock hound hunting area. The upper lake is quite shallow, about 14 feet in deepest place, average 7 feet. The BLM has recently built a boat ramp and campground at the narrows between the upper and lower lakes. The lower lake is very shallow and occasionally goes completely dry.

LAKE AND RESERVOIR ACCESS EVALUATION

Snake River System
Malheur County Area Priority Complete
Name Dunaway Pond County Malheur

Location 6 miles south of Nyssa on Highway 201
Township 20 S Range 47 E Sec. 18 Tax Lot No. _____
OSGC Agreement for access
Ownership Bureau of Reclamation Number of owners 1

DESCRIPTION

Terrain Level fields with cut bank on west side
Cover type Grass, cottonwoods and cattails
Existing access Single-lane gravel road
Surface acres 5 Water quality Good Levels Stable
Present stage of development Access road

ANGLER NEEDS

Acquisition: _____ acres, _____ of frontage
Type of conveyance _____

Development:

Boat ramp: Type _____ Number of lanes _____

Toilets _____ Trails _____ Roads _____

Parking area _____; for _____ cars or _____ car-trailer units

This site provides an excellent warm-water fishery.

Name Dunaway Pond

FISHERY: Bass, bluegill. The fish in this pond attain a very desirable size.

	Spring	Summer	Fall	Winter
Heavy				
Medium				
Light	Ww	Ww	Ww	

(Sa - Salmon, Tr - Trout,
Ww - Warm Water Fishes)

SKETCH

(See Malheur County map for location)

Seasons (Check)

RECREATION
(Check)

	Spring	Summer	Fall	Winter
Boating, motor				
Boating, non-motor				
Camping, tent				
Camping, trailer				
Fishing, boat				
Fishing, shore	X	X	X	X
Hiking				
Horseback riding				
Hunting, big game				
Hunting, upland game				
Hunting, waterfowl				
Nature study				
Picnicking				
Sightseeing				
Skin and scuba diving				
Swimming				
Water skiing				

OTHER

Safety Problems:

Group Facilities:

REMARKS

This pond was formed when gravel was taken for the Owyhee Dam. The pond is fed by spring.

LAKE AND RESERVOIR ACCESS EVALUATION

Malheur River System
Malheur County Area Priority C
Name Granite Creek Reservoir County Malheur

Location 4 miles southeast of Riverside
Township 24 S Range 38 E Sec. 17 Tax Lot No. 1400, 300
Ownership Bureau of Land Management & private Number of owners 1

DESCRIPTION

Terrain Deep, narrow canyon
Cover type Sagebrush and bunch grass
Existing access Private - unimproved dirt
Surface acres 14.7 * Water quality Fair Levels 149.6 acre/feet of storage
Present stage of development Primitive boat ramp

ANGLER NEEDS

Acquisition: _____ acres, _____ of frontage
Easement over road to reservoir.
Type of conveyance Land at reservoir is U. S. Government.

Development:

Boat ramp: Type Concrete plank Number of lanes 1
Toilets X Trails _____ Road Improvement
Parking area X; for _____ cars or * car-trailer units

This site will provide improved access to the reservoir.

* As many as the terrain will permit.

FISHERY: Black bass

	Spring	Summer	Fall	Winter
Heavy				
Medium				
Light	BB	BB	BB	

(Sa - Salmon, Tr - Trout,
Ww - Warm Water Fishes)

BB - Black bass

SKETCH

(See Malheur County map for location)

Seasons (Check)

RECREATION
(Check)

- Boating, motor
- Boating, non-motor
- Camping, tent
- Camping, trailer
- Fishing, boat
- Fishing, shore
- Hiking
- Horseback riding
- Hunting, big game
- Hunting, upland game
- Hunting, waterfowl
- Nature study
- Picnicking
- Sightseeing
- Skin and scuba diving
- Swimming
- Water skiing

	Spring	Summer	Fall	Winter
Boating, motor	X	X	X	
Boating, non-motor	X	X	X	
Camping, tent				
Camping, trailer				
Fishing, boat	X	X	X	
Fishing, shore	X	X	X	
Hiking				
Horseback riding				
Hunting, big game				
Hunting, upland game			X	X
Hunting, waterfowl				
Nature study				
Picnicking				
Sightseeing				
Skin and scuba diving				
Swimming	X	X	X	
Water skiing				

OTHER

Safety Problems:

Group Facilities:

REMARKS

This reservoir is located in a deep narrow canyon where any development would be difficult. Desired development would be to level off a small area for parking and improve the boat launch site. There is very little room for camping.

LAKE AND RESERVOIR ACCESS EVALUATION

Owyhee System
Malheur County Area Priority B
Name Littlefield Reservoir County Malheur

Location 25 miles east of Riverside
Township 24 S Range 40 E Sec. 8 Tax Lot No. _____
Ownership BLM Number of owners _____

DESCRIPTION

Terrain Rolling hills
Cover type Scab rock and sagebrush
Existing access Single-lane dirt road
Surface acres 3+ Water quality Good Levels Stable
Present stage of development Access road

ANGLER NEEDS

Acquisition: Reservoir acres, _____ of frontage
Type of conveyance Purchase

Development:

Boat ramp: Type _____ Number of lanes _____
Toilets _____ Trails _____ Roads _____
Parking area _____; for _____ cars or _____ car-trailer units

This site provides a trout fishery and a spot for camping for hunters in
the fall.

FISHERY: Rainbow trout up to 12 inches.

	Spring	Summer	Fall	Winter
Heavy				
Medium				
Light	Tr	Tr	Tr	

(Sa - Salmon, Tr - Trout, Ww - Warm Water Fishes)

SKETCH

Seasons (Check)

RECREATION
(Check)

- Boating, motor
- Boating, non-motor
- Camping, tent
- Camping, trailer
- Fishing, boat
- Fishing, shore
- Hiking
- Horseback riding
- Hunting, big game
- Hunting, upland game
- Hunting, waterfowl
- Nature study
- Picnicking
- Sightseeing
- Skin and scuba diving
- Swimming
- Water skiing

	Spring	Summer	Fall	Winter
	x	x	x	
	x	x	x	
			x	
			x	

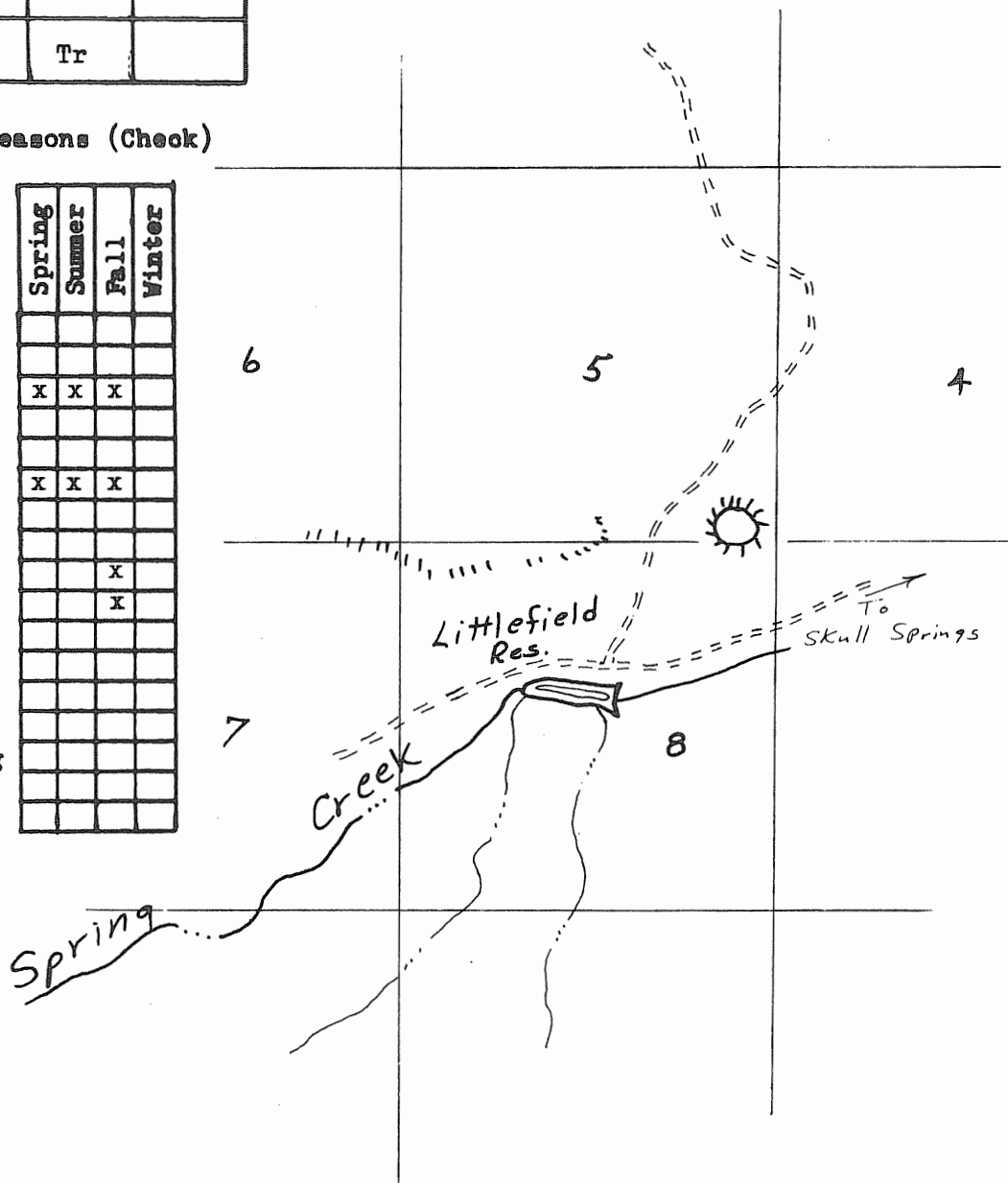

OTHER

Safety Problems:

Group Facilities:

REMARKS

The reservoir has a concrete dam, the bottom has silted and cannot be used for irrigation. It would be desirable to purchase the reservoir, remove silt and open to fishing since it grows good trout.

MALHEUR RESERVOIR

Malheur Reservoir, sometimes called Willow Creek Reservoir, is located on Willow Creek 14 miles northwest of Brogan. The reservoir covers 1,387 surface acres and is drawn down about 15 feet in normal years.

The reservoir gets moderate angler use through the general trout season but the lake is fished heavily on opening weekend and into May. It is stocked each year with 130,000 rainbow fingerling. In 1965 success was good at 4.1 fish per angler day. Most fish ranged from 8 to 10 inches in length.

The present access sites at the lake need improvement and further development. Three undeveloped waysides exist on the northeast shore of the lake; two have poorly maintained boat ramps. These waysides all need improvement and further development. Also, the southwest shore of the lake needs to be made accessible to bank anglers via the construction of a road along this side of the reservoir.

LAKE AND RESERVOIR ACCESS EVALUATION

Malheur River System
Malheur County Area Priority A
Name Domby access County Malheur
Malheur Reservoir

Location Near dam of Malheur Reservoir, northeast bank
Township 14 S Range 41 E Sec. 10 Tax Lot No. _____
Ownership Malheur County perpetual easement Number of owners _____

DESCRIPTION

Terrain Rolling hills
Cover type Sagebrush and bunch grass
Existing access County single-lane dirt
Surface acres 1,387 Water quality Good Levels Quite stable *
Present stage of development Two toilets

* Reservoir fluctuates only 15 feet in normal years.

ANGLER NEEDS

Acquisition: _____ acres, _____ of frontage
Type of conveyance _____

Development:

Boat ramp: Type Concrete plank Number of lanes 1
Toilets X Trails _____ Road Improvement
Parking area _____; for _____ cars or _____ car-trailer units

This site will accommodate trout anglers on Malheur Reservoir.

FISHERY: Rainbow trout

Spring Summer Fall Winter

Heavy	Tr			
Medium			Tr	
Light		Tr		

(Sa - Salmon, Tr - Trout,
 Ww - Warm Water Fishes)

SKETCH

Seasons (Check)

RECREATION
 (Check)

- Boating, motor
- Boating, non-motor
- Camping, tent
- Camping, trailer
- Fishing, boat
- Fishing, shore
- Hiking
- Horseback riding
- Hunting, big game
- Hunting, upland game
- Hunting, waterfowl
- Nature study
- Picnicking
- Sightseeing*
- Skin and scuba diving
- Swimming
- Water skiing

	Spring	Summer	Fall	Winter
Boating, motor	X	X	X	
Boating, non-motor	X	X	X	
Camping, tent	X	X	X	
Camping, trailer	X	X	X	
Fishing, boat	X	X	X	
Fishing, shore	X	X	X	
Hiking				
Horseback riding				
Hunting, big game			X	
Hunting, upland game			X	
Hunting, waterfowl			X	
Nature study				
Picnicking	X	X	X	
Sightseeing*	X	X	X	
Skin and scuba diving				
Swimming		X	X	
Water skiing				

* The old town of Malheur is of interest to tourists.

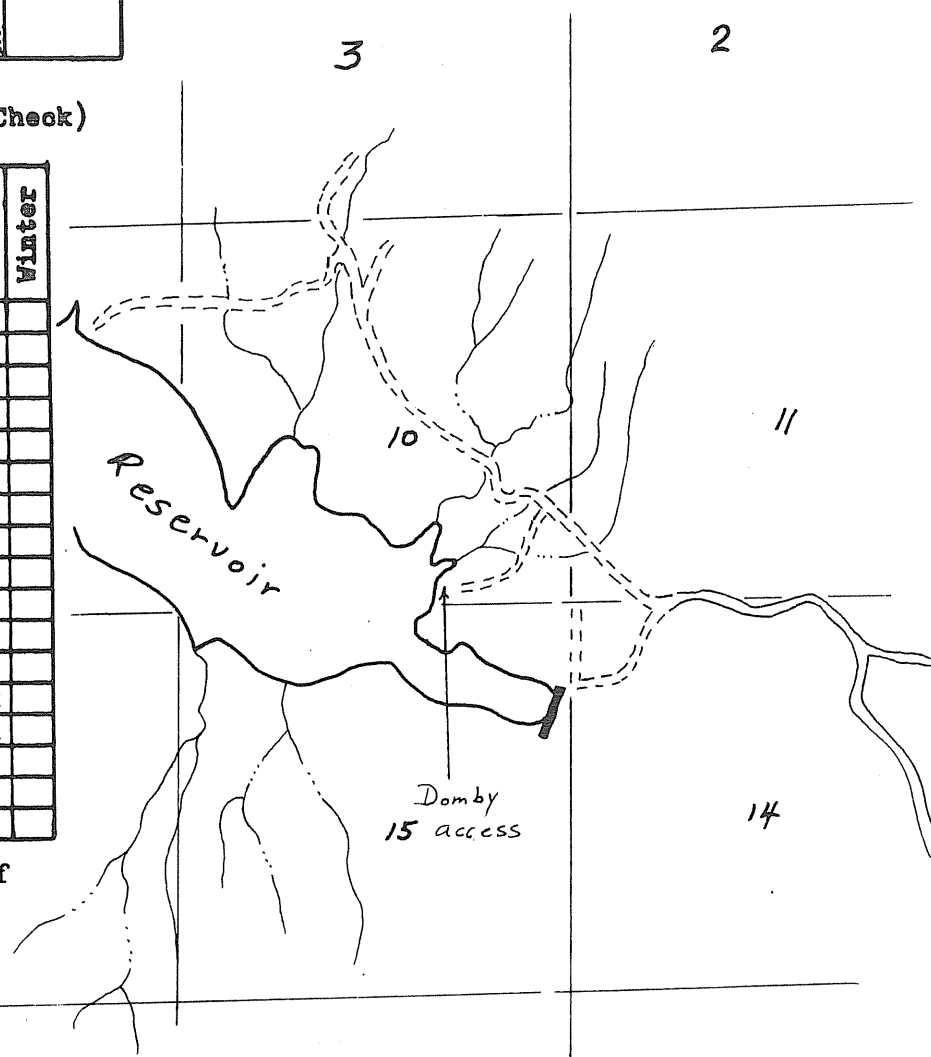

OTHER

Safety Problems: Steep bank - 16 feet to water over cliff.

Group Facilities:

REMARKS

This camping area would be enhanced by shade trees. Domestic water and additional toilets are needed. This gets heavy use - as many as 2,500 anglers on open weekend on the entire reservoir.

LAKE AND RESERVOIR ACCESS EVALUATION

Malheur River System

Malheur County Area

Priority C

Name Locey Access
Malheur Reservoir

County Malheur

Location On northeast side of Malheur Reservoir, northeast bank

Township 14 S Range 41 E Sec. 10 Tax Lot No. _____

Ownership Game Commission perpetual easement Number of owners _____

DESCRIPTION

Terrain Rolling hills

Cover type Sagebrush and bunch grass

Existing access County single-lane dirt

Surface acres _____ Water quality Good Levels * Quite stable

Present stage of development Two poorly constructed toilets

* Reservoir fluctuates only 15 feet in normal years

ANGLER NEEDS

Acquisition: _____ acres, _____ of frontage

Type of conveyance _____

Development:

Boat ramp: Type Concrete plank * Number of lanes 1

Toilets _____ Trails _____ Roads _____

Parking area _____; for _____ cars or _____ car-trailer units

This site will accommodate trout anglers on Malheur Reservoir.

* Asphalt ramp only lasted two years.

FISHERY: Rainbow trout

Spring Summer Fall Winter

Heavy	Tr			
Medium			Tr	
Light		Tr		

(Sa - Salmon, Tr - Trout,
Ww - Warm Water Fishes)

SKETCH

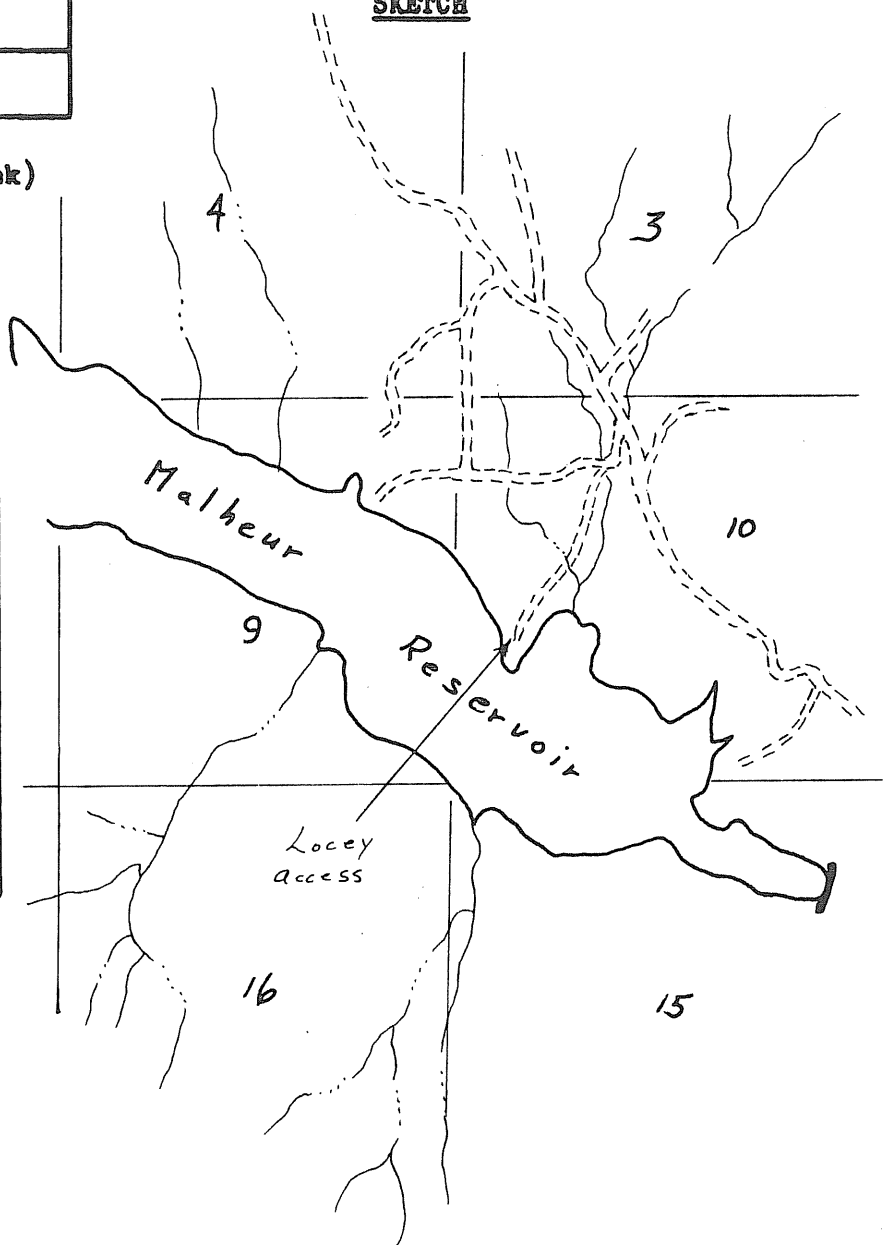

Seasons (Check)

	Spring	Summer	Fall	Winter
X	X	X		
X	X	X		
X	X	X		
X	X	X		
X	X	X		
X	X	X		
			X	
			X	
			X	
X	X	X		
X	X	X		
	X	X		

RECREATION (Check)

- Boating, motor
- Boating, non-motor
- Camping, tent
- Camping, trailer
- Fishing, boat
- Fishing, shore
- Hiking
- Horseback riding
- Hunting, big game
- Hunting, upland game
- Hunting, waterfowl
- Nature study
- Picnicking
- Sightseeing*
- Skin and scuba diving
- Swimming
- Water skiing

* The old town of Malheur is of interest to tourists

OTHER

Safety Problems:

Group Facilities:

REMARKS

This area would be enhanced by a domestic water supply and shade trees. Area is now void of all vegetation.

LAKE AND RESERVOIR ACCESS EVALUATION

Malheur River System
Malheur County Area Priority C
Name Head of Reservoir Wayside County Malheur
Malheur Reservoir

Location At head end of reservoir on north side
Township 14 S Range 41 E Sec. 4 Tax Lot No. 700
Ownership Private Number of owners 1

DESCRIPTION

Terrain Rolling hills
Cover type Sagebrush and bunch grass
Existing access County single-lane dirt
Surface acres 1,387 Water quality _____ Levels High - Spring
Good - Summer & fall
Present stage of development Two toilets

ANGLER NEEDS

Acquisition: _____ acres, _____ of frontage
Type of conveyance Perpetual easement
Development: *
Boat ramp: Type _____ Number of lanes _____
Toilets X Trails _____ Roads _____
Parking area _____; for _____ cars or _____ car-trailer units

This site will accommodate trout anglers on Malheur Reservoir.

* Better toilets and running water would greatly enhance this location.

Head of
Name Reservoir Wayside
Malheur Reservoir

FISHERY: Rainbow trout

	Spring	Summer	Fall	Winter
Heavy	Tr			
Medium			Tr	
Light		Tr		

(Sa - Salmon, Tr - Trout, Ww - Warm Water Fishes)

SKETCH

Seasons (Check)

RECREATION
(Check)

	Spring	Summer	Fall	Winter
Boating, motor				
Boating, non-motor				
Camping, tent	X	X	X	
Camping, trailer	X	X	X	
Fishing, boat				
Fishing, shore	X	X	X	
Hiking				
Horseback riding				
Hunting, big game				
Hunting, upland game				
Hunting, waterfowl				
Nature study				
Picnicking				
Sightseeing				
Skin and scuba diving				
Swimming				
Water skiing				

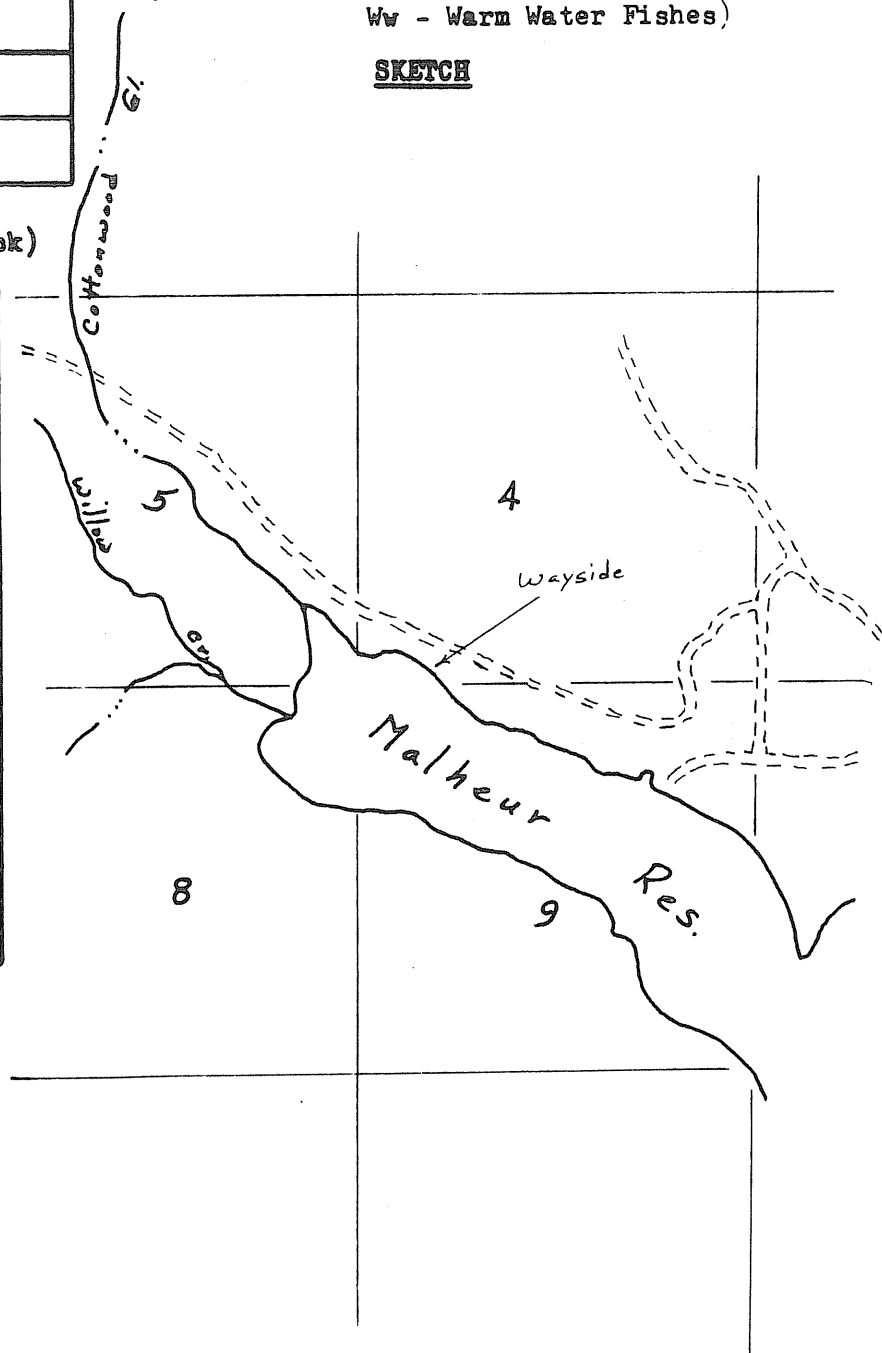

OTHER

Safety Problems:

Group Facilities:

REMARKS

This is a nice camping location at the head end of the reservoir.
Improvement of the facilities would make this a more desirable place to stay.

LAKE AND RESERVOIR ACCESS EVALUATION

Malheur River System
Malheur County Area Priority A
Name Southwest access road County Malheur
Malheur Reservoir

Location Along southwest shoreline of reservoir
Township 14 S Range 41 E Sec. _____ Tax Lot No. _____
Ownership Private Number of owners Many

DESCRIPTION

Terrain Rolling hills
Cover type Sagebrush and bunch grass
Existing access None
Surface acres 1,387 Water quality Good Levels Quite stable *
Present stage of development _____

* Reservoir fluctuates only 15 feet in normal years.

ANGLER NEEDS

Acquisition: _____ acres, _____ of frontage
Perpetual easement along entire southwest
Type of conveyance shoreline.

Development:

Boat ramp: Type _____ Number of lanes _____
Toilets _____ Trails _____ Road Construction
Parking area _____; for _____ cars or _____ car-trailer units

This site will accommodate bank anglers along the southwest shoreline of
the reservoir.

FISHERY: Rainbow trout

Spring Summer Fall Winter

Heavy	Tr			
Medium			Tr	
Light		Tr		

(Sa - Salmon, Tr - Trout,
 Ww - Warm Water Fishes)

SKETCH

(See Malheur County map for location)

Seasons (Check)

	Spring	Summer	Fall	Winter
	X	X	X	
	X	X	X	

RECREATION
 (Check)

- Boating, motor
- Boating, non-motor
- Camping, tent
- Camping, trailer
- Fishing, boat
- Fishing, shore
- Hiking
- Horseback riding
- Hunting, big game
- Hunting, upland game
- Hunting, waterfowl
- Nature study
- Picnicking
- Sightseeing
- Skin and scuba diving
- Swimming
- Water skiing

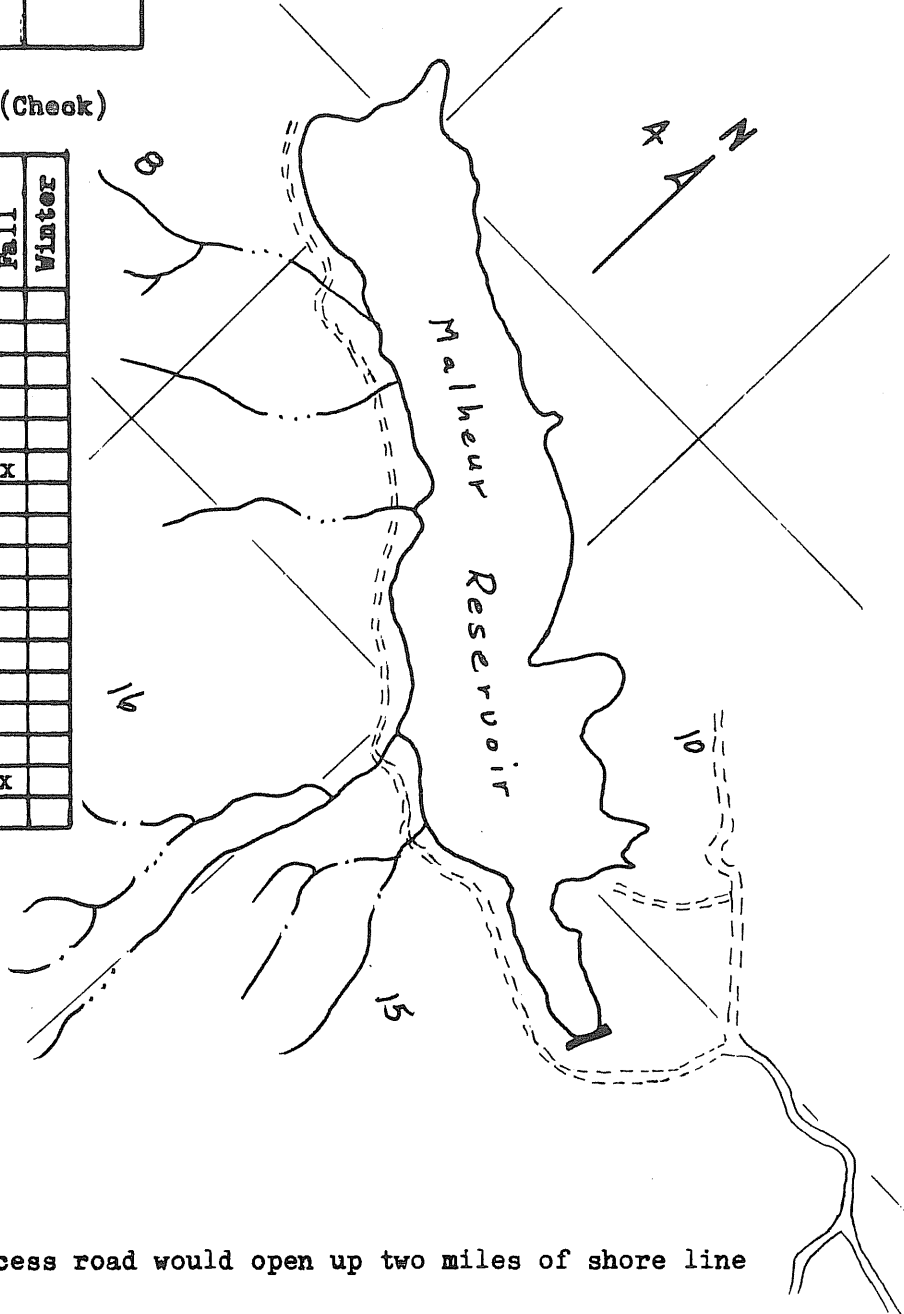

OTHER

Safety Problems:

Group Facilities:

REMARKS

The construction of this access road would open up two miles of shore line to bank anglers.

LAKE AND RESERVOIR ACCESS EVALUATION

Owyhee System
Malheur County Area Priority B
Name Odom Reservoir County Malheur

Location 17 miles east of Cow Lakes
Township 28 S Range 46 E Sec. 21 Tax Lot No. _____
Ownership Spencer Maughn Number of owners 1

DESCRIPTION

Terrain Rolling hills
Cover type Sagebrush and scattered juniper
Existing access Single-lane dirt road
Surface acres 40+ Water quality Good Levels Fluctuate
Present stage of development None

ANGLER NEEDS

Acquisition: _____ acres, _____ of frontage
Type of conveyance Purchase reservoir

Development:

Boat ramp: Type _____ Number of lanes _____
Toilets _____ Trails _____ Roads _____
Parking area _____; for _____ cars or _____ car-trailer units

This site is denied access to everyone by the landowner.

Name Odom Reservoir

FISHERY: Bullheads

	Spring	Summer	Fall	Winter
Heavy				
Medium				
Light				

(Sa - Salmon, Tr - Trout,
Ww - Warm Water Fishes)

SKETCH

Seasons (Check)

RECREATION
(Check)

- Boating, motor
- Boating, non-motor
- Camping, tent
- Camping, trailer
- Fishing, boat
- Fishing, shore
- Hiking
- Horseback riding
- Hunting, big game
- Hunting, upland game
- Hunting, waterfowl
- Nature study
- Picnicking
- Sightseeing
- Skin and scuba diving
- Swimming
- Water skiing

	Spring	Summer	Fall	Winter

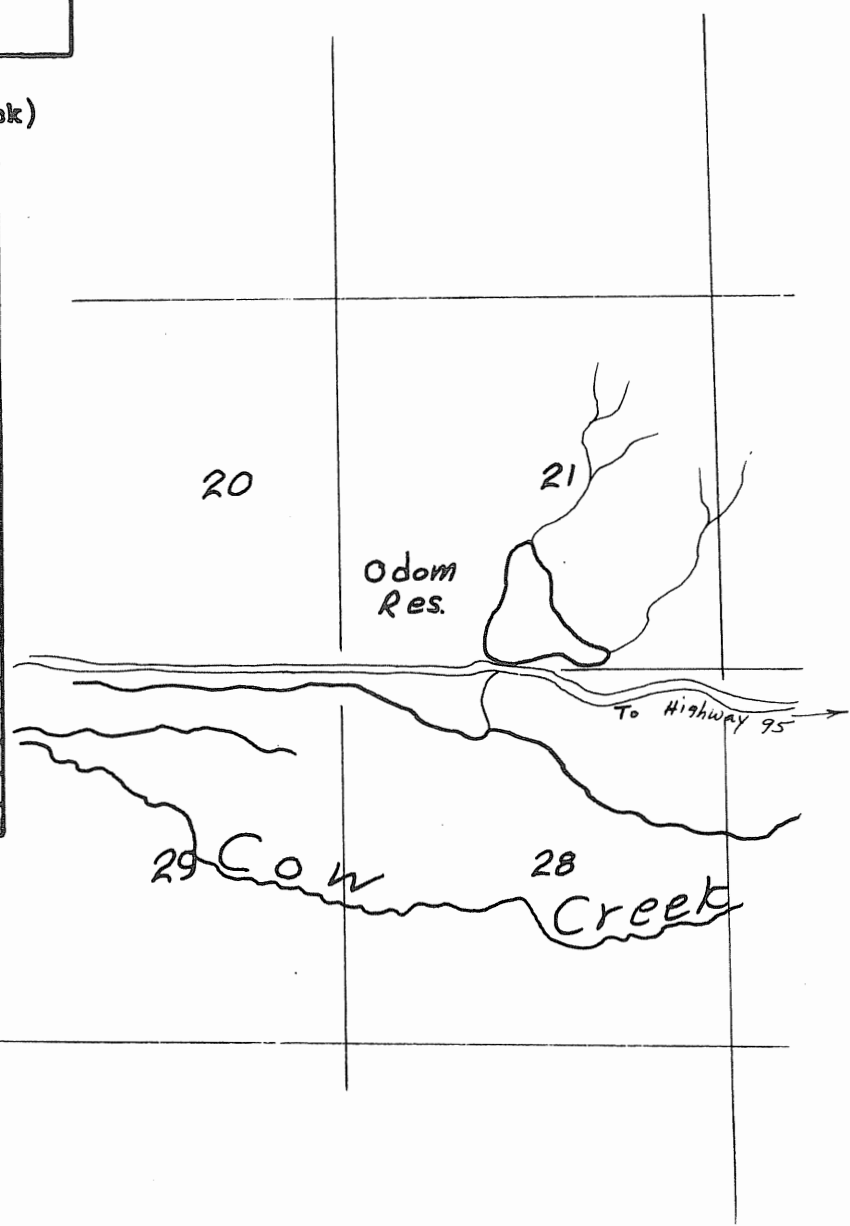

OTHER

Safety Problems:

Group Facilities:

REMARKS

This reservoir is drained down for irrigation and the owner allows no public entry. It would be a desirable reservoir to obtain for fishing purposes.

OWYHEE RESERVOIR

Owyhee Reservoir is situated in a steep, rocky canyon. The concrete dam backs water for 40 miles.

This is a remote and desolate area. The rimrocks in many places emerge from the depths of the reservoir and the hillsides are bare except for thin stands of short sage and bunchgrass. In places the topography looks as if it had been transplanted from the "craters of the moon".

Fishing is mainly a spring operation when the crappies and bass are active. Angling pressure is considered moderate by southeastern Oregon standards.

The only boat ramps on the reservoir are in the vicinity of the dam and resort. The county maintains a paved ramp and small parking area about one-half mile above the dam. There is a paved ramp near the Gordon Gulch Picnic Area and a gravel ramp at the V. W. McCormack Picnic and Camping Area. The resort also has a paved ramp.

Drift boating the section from Rome to the reservoir is becoming more popular every year. There is one take-out point at Leslie Gulch. The other point is at the Morcom Ranch, about 10 miles above the head of the reservoir.

Dry Creek, Deadman Gulch, and the head of the reservoir at one time were accessible by road, but roads are now poor or washed out. The only access to the east side is down Leslie Gulch from the Succor Creek road. The Morcom Ranch is accessible via Cow Lakes and "The Craters".

All in all this is a remote and desolate canyon that has been filled with life-giving water for irrigation of the Vale-Ontario agricultural area. Some access improvement is recommended; and, in one instance, preservation of a natural geological phenomenon is advocated. The following evaluation forms describe the area in more detail.

LAKE AND RESERVOIR ACCESS EVALUATION

Owyhee System
Owyhee Reservoir Area Priority Complete
Name County Boat Ramp County Malheur
Owyhee Reservoir

Location 1/2 mile up reservoir from the dam
Township 22 S Range 45 E Sec. 21 Tax Lot No. _____
Ownership Malheur County Number of owners 1

DESCRIPTION

Terrain Rimrocks
Cover type None
Existing access Paved highway
Surface acres 12,740 Water quality Good Levels Fluctuate
Present stage of development Complete

ANGLER NEEDS

Acquisition: _____ acres, _____ of frontage
Type of conveyance _____

Development:
Boat ramp: Type _____ Number of lanes _____
Toilets _____ Trails _____ Roads _____
Parking area _____; for _____ cars or _____ car-trailer units

This site was developed before the State Park and at that time was the only
ramp on the reservoir.

FISHERY: Crappie and bass

	Spring	Summer	Fall	Winter
Heavy				
Medium	Ww			
Light		Ww	Ww	

(Sa - Salmon, Tr - Trout,
Ww - Warm Water Fishes)

SKETCH

(See Malheur County map for
location)

Seasons (Check)

RECREATION
(Check)

	Spring	Summer	Fall	Winter
Boating, motor	X	X	X	
Boating, non-motor	X	X	X	
Camping, tent				
Camping, trailer				
Fishing, boat	X	X	X	
Fishing, shore	X	X	X	
Hiking				
Horseback riding				
Hunting, big game				
Hunting, upland game				
Hunting, waterfowl				
Nature study				
Picnicking				
Sightseeing				
Skin and scuba diving				
Swimming				
Water skiing		X	X	

OTHER

Safety Problems:

Group Facilities:

REMARKS

This ramp was built by the Oregon Game Commission when a ramp was desperately needed years ago before the development of the State Park. Parking is limited at a lot on the hill above the ramp.

LAKE AND RESERVOIR ACCESS EVALUATION

Owyhee System
Owyhee Reservoir Area Priority Complete
Name Lake Owyhee State Park County Malheur

Location 2 miles up from the dam on the east side
Township 22 S Range 45 E Sec. 28 Tax Lot No. _____
Ownership Oregon State Highway Department Number of owners _____

DESCRIPTION

Terrain Rolling hills at base of rimrocks
Cover type Shade trees and grass in park
Existing access Paved highway
Surface acres 12,740 Water quality Good Levels Fluctuate
Present stage of development Complete

ANGLER NEEDS

Acquisition: _____ acres, _____ of frontage
Type of conveyance _____

Development:

Boat ramp: Type _____ Number of lanes _____
Toilets _____ Trails _____ Roads _____
Parking area _____; for _____ cars or _____ car-trailer units

_____ These sites provide a picnicking and camping area at the end of
_____ the highway on the reservoir.

LAKE AND RESERVOIR ACCESS EVALUATION

Owyhee System
Owyhee Reservoir Area Priority Complete
Name Lake Owyhee Resort County Malheur

Location At the end of the Lake Owyhee access road
Township 22 S Range 45 E Sec. 29 Tax Lot No. _____
Ownership Private Number of owners _____

DESCRIPTION

Terrain Rolling hills at base of rimrocks
Cover type A few shade trees and grass
Existing access Paved highway
Surface acres 12,740 Water quality Good Levels Fluctuate
Present stage of development Complete

ANGLER NEEDS

Acquisition: _____ acres, _____ of frontage
Type of conveyance _____

Development:

Boat ramp: Type _____ Number of lanes _____
Toilets _____ Trails _____ Roads _____
Parking area _____; for _____ cars or _____ car-trailer units

This resort provides the needed concessionary facilities
at the lake.

FISHERY: Crappie and bass

	Spring	Summer	Fall	Winter
Heavy				
Medium	Ww			
Light		Ww	Ww	

(Sa - Salmon, Tr - Trout,
Ww - Warm Water Fishes)

SKETCH

(See Lower Owyhee River Basin map for location)

Seasons (Check)

RECREATION
(Check)

	Spring	Summer	Fall	Winter
Boating, motor	X	X	X	
Boating, non-motor	X	X	X	
Camping, tent	X	X	X	
Camping, trailer	X	X	X	
Fishing, boat	X	X	X	
Fishing, shore	X	X	X	
Hiking				
Horseback riding				
Hunting, big game			X	
Hunting, upland game			X	X
Hunting, waterfowl			X	X
Nature study				
Picnicking	X	X	X	
Sightseeing	X	X	X	
Skin and scuba diving				
Swimming		X	X	
Water skiing		X	X	

OTHER

Safety Problems:

Group Facilities: Parking for buses.

REMARKS

This is a modern lodge with motel type units. The lodge provides a boat ramp, marina, moorage, boat rental, restaurant, store and tackle shop.

LAKE AND RESERVOIR ACCESS EVALUATION

Owyhee System
Owyhee Reservoir Area Priority C
Name Dry Creek Arm County Malheur
Owyhee Reservoir

Location 10 miles up the reservoir and 1 1/2 miles up Dry Creek Arm
Township 23 S Range 43 E Sec. 13 & 24 Tax Lot No. _____
Ownership BLM & Bureau of Reclamation Number of owners 2

DESCRIPTION

Terrain Rolling mountains and rimrocks
Cover type Short sage and grass
Existing access Poor dirt road
Surface acres 12,740 Water quality Good Levels Fluctuate
Present stage of development None

ANGLER NEEDS

Acquisition: _____ acres, _____ of frontage
Type of conveyance _____
Development:
Boat ramp: Type _____ Number of lanes _____
Toilets X Trails _____ Road Improvement
Parking area X; for 10 cars or _____ car-trailer units
This site will give the only road access to the west side of the
reservoir.

Name Dry Creek Arm
Owyhee Reservoir

FISHERY: Crappie and bass in the reservoir.

	Spring	Summer	Fall	Winter
Heavy				
Medium				
Light	Ww	Ww	Ww	

(Sa - Salmon, Tr - Trout,
 Ww - Warm Water Fishes)

SKETCH

Seasons (Check)

RECREATION
 (Check)

- Boating, motor
- Boating, non-motor
- Camping, tent
- Camping, trailer
- Fishing, boat
- Fishing, shore
- Hiking
- Horseback riding
- Hunting, big game
- Hunting, upland game
- Hunting, waterfowl
- Nature study
- Picnicking
- Sightseeing
- Skin and scuba diving
- Swimming
- Water skiing

	Spring	Summer	Fall	Winter
X	X	X		
X	X	X		
X	X	X		
X	X	X		
X	X	X		
X	X	X		
			X	
			X	X
			X	X
X	X	X		
X	X	X		
		X	X	
		X	X	

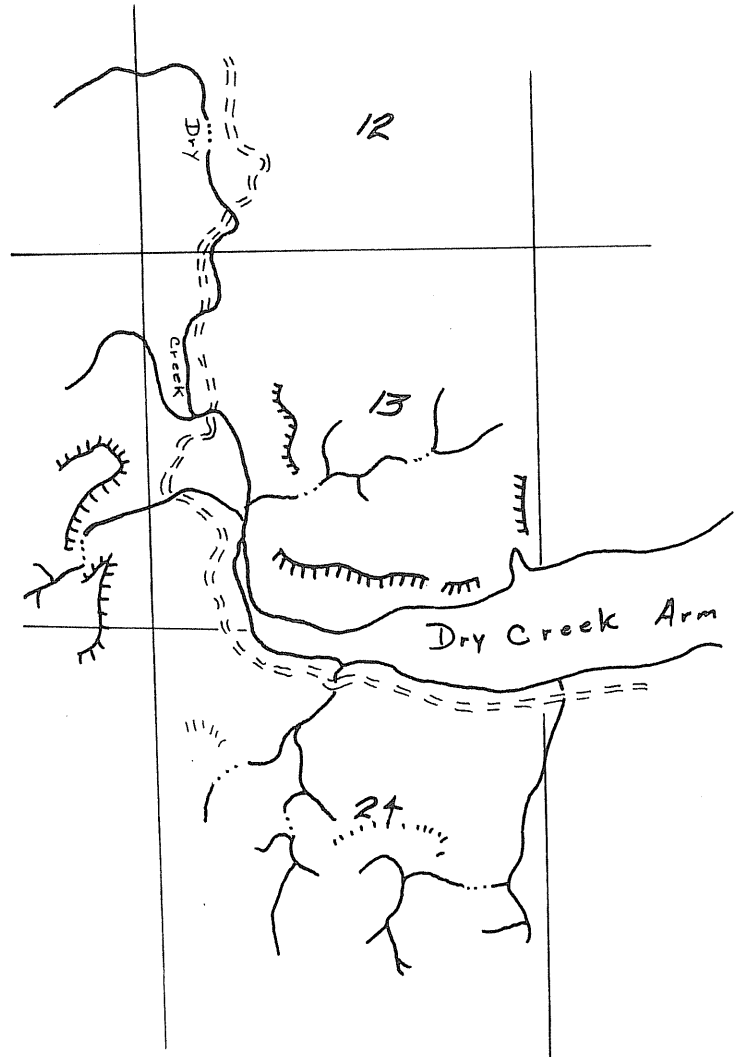

OTHER

Safety Problems:

Group Facilities:

REMARKS

At Twin Springs, about 5 miles north of the end of the arm, there is a BLM campground that can be reached by car. From there to the reservoir, the road is poor. It is recommended that the road from the spring to the reservoir be improved and a campground be built at the reservoir.

LAKE AND RESERVOIR ACCESS EVALUATION

Owyhee System
Owyhee Reservoir Area Priority A
Name Deadman Gulch County Malheur
Owyhee Reservoir

Location 21 miles up the reservoir
Township 24 S Range 44 E Sec. 32 Tax Lot No. _____
Ownership Bureau of Reclamation Number of owners _____

DESCRIPTION

Terrain Rolling mountains
Cover type Short sage and grass
Existing access None - road is washed out
Surface acres 12,740 Water quality Good Levels Fluctuate
Present stage of development Unimproved road

ANGLER NEEDS

Acquisition: _____ acres, _____ of frontage
Type of conveyance _____

Development:

Boat ramp: Type _____ Number of lanes _____
Toilets X Trails _____ Roads Improvement
Parking area X; for 20 cars or _____ car-trailer units

This site provides the best angling during the spring months when crappie
and bass are active.

Name Deadman Gulch
Owyhee Reservoir

FISHERY: Crappie and bass

	Spring	Summer	Fall	Winter
Heavy				
Medium				
Light	Ww	Ww	Ww	

(Sa - Salmon, Tr - Trout,
 Ww - Warm Water Fishes)

SKETCH

Seasons (Check)

RECREATION
 (Check)

- Boating, motor
- Boating, non-motor
- Camping, tent
- Camping, trailer
- Fishing, boat
- Fishing, shore
- Hiking
- Horseback riding
- Hunting, big game
- Hunting, upland game
- Hunting, waterfowl
- Nature study
- Picnicking
- Sightseeing
- Skin and scuba diving
- Swimming
- Water skiing

	Spring	Summer	Fall	Winter
Boating, motor	x	x	x	
Boating, non-motor	x	x	x	
Camping, tent	x	x	x	
Camping, trailer				
Fishing, boat	x	x	x	
Fishing, shore	x	x	x	
Hiking	x	x	x	
Horseback riding				
Hunting, big game			x	
Hunting, upland game			x	x
Hunting, waterfowl			x	x
Nature study				
Picnicking	x	x	x	
Sightseeing				
Skin and scuba diving				
Swimming		x	x	
Water skiing		x	x	

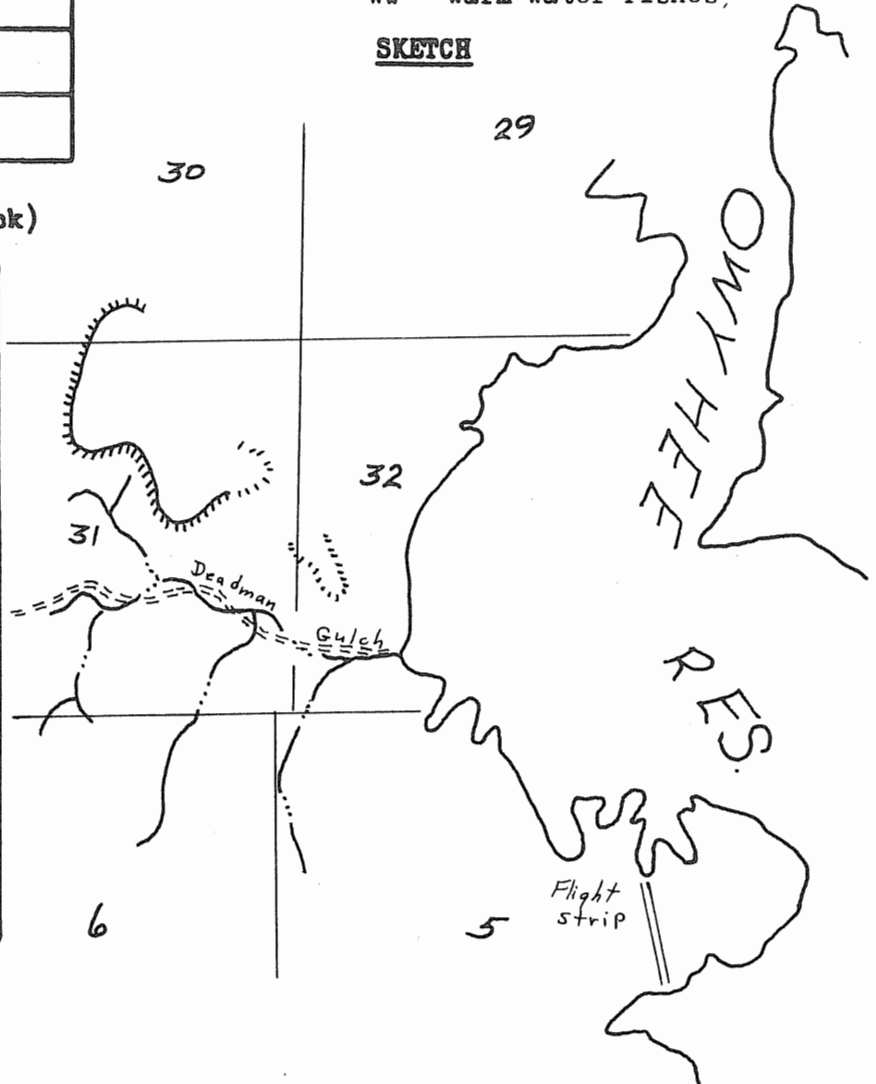

OTHER

Safety Problems:

Group Facilities:

REMARKS

The road that branches off the road from Dry Creek to the head of the reservoir is washed out. The air strip is about 1/2 mile up the reservoir from the gulch. It is recommended that the road be repaired and improved and a camping area be built on the reservoir at the gulch or near the air strip.

LAKE AND RESERVOIR ACCESS EVALUATION

Owyhee System
Owyhee Reservoir Area Priority Complete
Name Leslie Gulch County Malheur
Owyhee Reservoir

Location 8 miles from the head of the reservoir
Township 26 S Range 44 E Sec. _____ Tax Lot No. _____
Ownership Bureau of Land Management Number of owners _____

DESCRIPTION

Terrain Steep, rocky canyon
Cover type Short sage and grass
Existing access Single-lane dirt road
Surface acres 12,740 Water quality Good Levels Fluctuate
Present stage of development None

ANGLER NEEDS

Acquisition: _____ acres, _____ of frontage
Type of conveyance _____

Development:

Boat ramp: Type _____ Number of lanes _____
Toilets _____ Trails _____ Roads _____
Parking area _____; for _____ cars or _____ car-trailer units

This site is extremely scenic and should not be improved.

Name Leslie Gulch
Owyhee Reservoir

FISHERY: Crappie and bass in the reservoir.

Spring Summer Fall Winter

Heavy				
Medium				
Light	Ww	Ww	Ww	

(Sa - Salmon, Tr - Trout,
Ww - Warm Water Fishes)

SKETCH

Seasons (Check)

RECREATION
(Choose)

- Boating, motor
- Boating, non-motor
- Camping, tent
- Camping, trailer
- Fishing, boat
- Fishing, shore
- Hiking
- Horseback riding
- Hunting, big game
- Hunting, upland game
- Hunting, waterfowl
- Nature study
- Picnicking
- Sightseeing
- Skin and scuba diving
- Swimming
- Water skiing

	Spring	Summer	Fall	Winter
Boating, motor	x	x	x	
Boating, non-motor	x	x	x	
Camping, tent	x	x	x	
Camping, trailer				
Fishing, boat	x	x	x	
Fishing, shore	x	x	x	
Hiking				
Horseback riding				
Hunting, big game				
Hunting, upland game				
Hunting, waterfowl				
Nature study				
Picnicking				
Sightseeing				
Skin and scuba diving				
Swimming				
Water skiing				

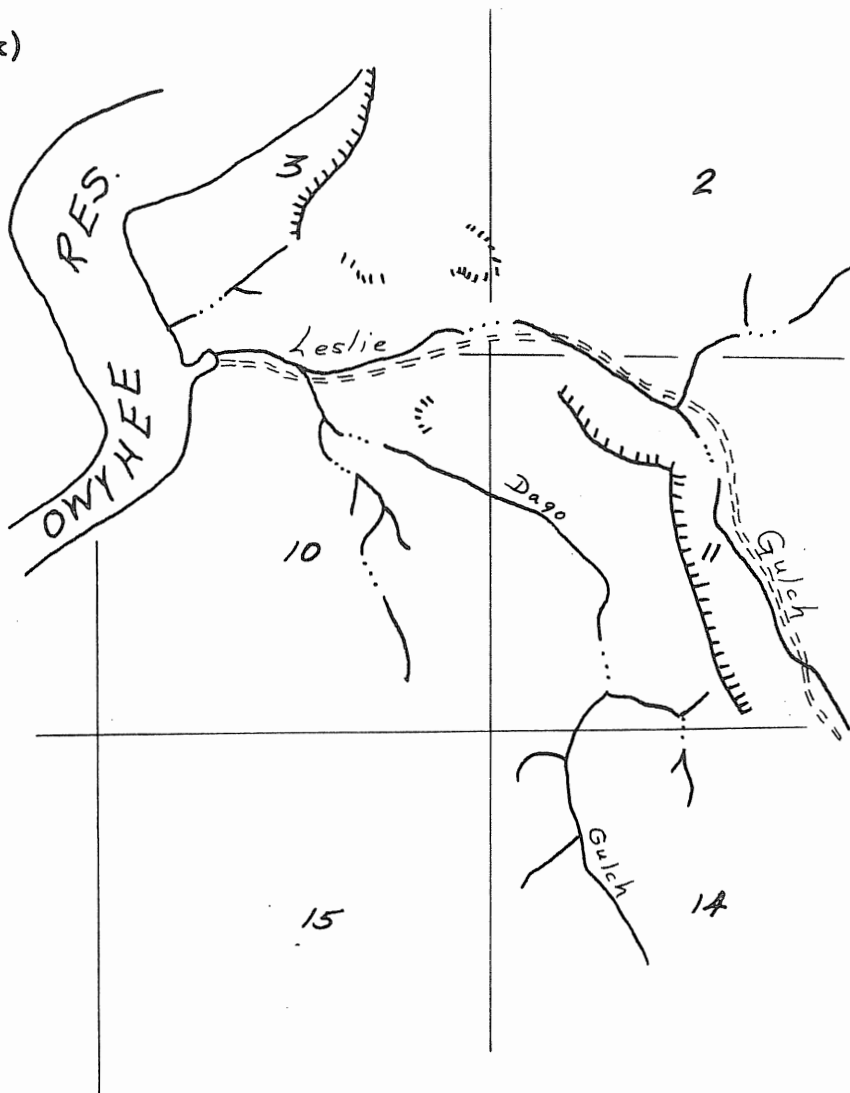

OTHER

Safety Problems:

Group Facilities:

REMARKS

This is a very scenic area and should not be disturbed. The road branches off the Succor Creek road and is about 21 miles down the gulch to the reservoir. The bottom 10 miles is the most scenic. There is a nice spring about 5 miles up the gulch from the reservoir. Drift boaters from Rome either take out here or at the Morcom Ranch, 10 miles above the head of the reservoir.

LAKE AND RESERVOIR ACCESS EVALUATION

Owyhee System
Malheur County Area Priority B
Name Rattlesnake Reservoir County Malheur

Location 28 miles southwest of Three Forks
Township 38 S Range 44 E Sec. 9 Tax Lot No. _____
Ownership BLM Number of owners _____

DESCRIPTION

Terrain Rolling hills
Cover type Sagebrush and scab rock
Existing access Single-lane dirt road
Surface acres 3 + Water quality Good Levels Stable
Present stage of development None

ANGLER NEEDS

Acquisition: Reservoir acres, _____ of frontage
Type of conveyance Purchase

Development:

Boat ramp: Type _____ Number of lanes _____
Toilets _____ Trails _____ Roads _____
Parking area _____; for _____ cars or _____ car-trailer units

This pond will provide a good trout fishery in 1968.

FISHERY: The pond was stocked with rainbow fingerling in the spring of 1967
and by fall they had attained 9" in length.

	Spring	Summer	Fall	Winter
Heavy				
Medium				
Light				

(Sa - Salmon, Tr - Trout,
 Ww - Warm Water Fishes)

SKETCH

(See Malheur County map for
 location)

Seasons (Check)

RECREATION
 (Check)

	Spring	Summer	Fall	Winter
Boating, motor				
Boating, non-motor				
Camping, tent			X	
Camping, trailer				
Fishing, boat				
Fishing, shore	X	X	X	
Hiking				
Horseback riding				
Hunting, big game			X	
Hunting, upland game			X	X
Hunting, waterfowl				
Nature study				
Picnicking				
Sightseeing				
Skin and scuba diving				
Swimming		X	X	
Water skiing				

OTHER

Safety Problems:

Group Facilities:

REMARKS

There is a road to the pond. The pond was built in 1966 and stocked for the first time in the spring of 1967.

LAKE AND RESERVOIR ACCESS EVALUATION

Malheur System
Malheur County Area Priority B
Name Vaughn Reservoir County Malheur

Location 12 miles northeast of Beulah Reservoir
Township 18 S Range 39 E Sec. 15 Tax Lot No. _____
Ownership BLM Number of owners _____

DESCRIPTION

Terrain Rolling mountains
Cover type Sagebrush, juniper and grass
Existing access Private dirt road
Surface acres 23 Water quality Excellent * Levels Fluctuate
Present stage of development None

* Partially spring fed

ANGLER NEEDS

Acquisition: _____ acres, _____ of frontage
Type of conveyance Purchase reservoir

Development:

Boat ramp: Type _____ Number of lanes _____
Toilets _____ Trails _____ Roads _____
Parking area _____; for _____ cars or _____ car-trailer units

This site is on public land but private land must be crossed to reach the
reservoir.

Name Vaughn Reservoir

FISHERY: The only fishery is in the creek above since the pool is drained
clear down each year.

	Spring	Summer	Fall	Winter
Heavy				
Medium				
Light				

(Sa - Salmon, Tr - Trout,
Ww - Warm Water Fishes)

SKETCH

(See Malheur County map for location)

Seasons (Check)

RECREATION
(Check)

	Spring	Summer	Fall	Winter
Boating, motor				
Boating, non-motor				
Camping, tent				
Camping, trailer				
Fishing, boat				
Fishing, shore				
Hiking				
Horseback riding				
Hunting, big game				
Hunting, upland game				
Hunting, waterfowl				
Nature study				
Picnicking				
Sightseeing				
Skin and scuba diving				
Swimming				
Water skiing				

OTHER

Safety Problems:

Group Facilities:

REMARKS

This reservoir has good fishery potential and should be purchased if ever possible.

LAKE AND RESERVOIR ACCESS EVALUATION

Harney County Area Priority B
 Name Stinkingwater Reservoir County Harney
 Location 5 miles southeast of Stinkingwater Pass
 Township 22 S Range 35 E Sec. 20 Ownership Private

DESCRIPTION

Terrain Rolling mountains
 Cover type Grass and sagebrush
 Elevation 4,500'+ Surface acres 68 Water quality Good
 Existing access None

ANGLER NEEDS

Establish a fishery and make the reservoir available to the public.

FISHERY

None

	Spring	Summer	Fall	Winter		<u>Recreation</u>			
						S	S	F	W
Heavy					Camping				
Medium					Fishing, boat				
Light					Fishing, shore				
					Hiking				
					Horseback riding				
					Hunting, big game				
					Hunting, upland game				
					Nature study				
					Picnicking				
					Sight-seeing				
					Swimming				
					Water skiing				

(Ct - Cutthroat trout, GT - Golden trout, LT - Lake trout, BT - Brook trout, Rb - Rainbow trout, Br - Brown trout, K - Kokanee, Ww - Warm water game fish)

REMARKS:

It would be desirable to purchase this reservoir if ever possible and establish a fishery.

See Harney County map for location.